

QUESTION 2 : GEOMETRICAL CONSTRUCTION

Given:

- A casting with all the necessary dimension.
- The position of A, B, C & D for the ellipse.
- Some of the center lines.

Instructions:

Copy the given view to scale 1:1.

Note:

ALL construction must be shown for maximum marks. **[28]**

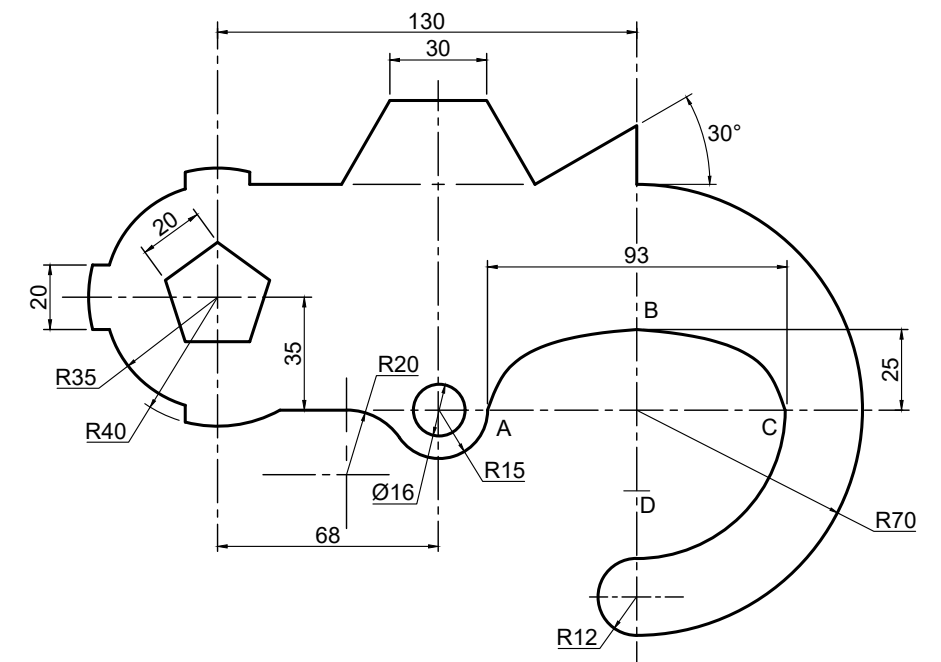
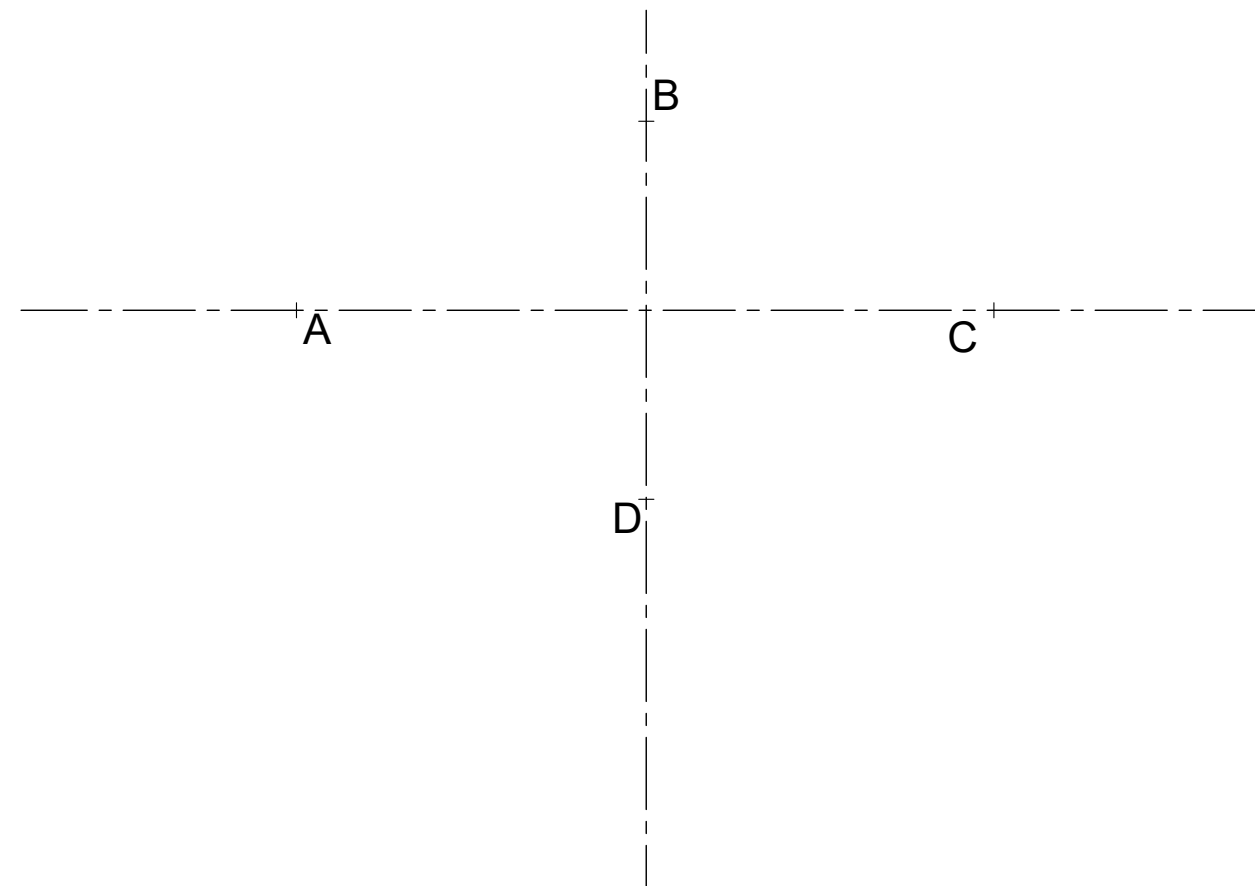

ASSESSMENT CRITERIA			
1	CIRCLES ($\frac{20}{2}$)	10	
2	POLYGONS ($\frac{8}{2}$)	4	
3	ELLIPSE ($\frac{19}{2}$)	9.5	
4	LINES ($\frac{8}{2}$)	4.5	
TOTAL		28	

