

QUESTION 3: ISOMETRIC

Given:

The front view, top view and left view of a casting.
The position of point S on the diagram sheet.

Instructions:

Use a scale of 1 : 1 and convert the orthographic views of the casting into an isometric drawing.

- Make S the lowest point of the drawing.
- Show all necessary constructions.
- NO hidden detail is required.

[16,5]

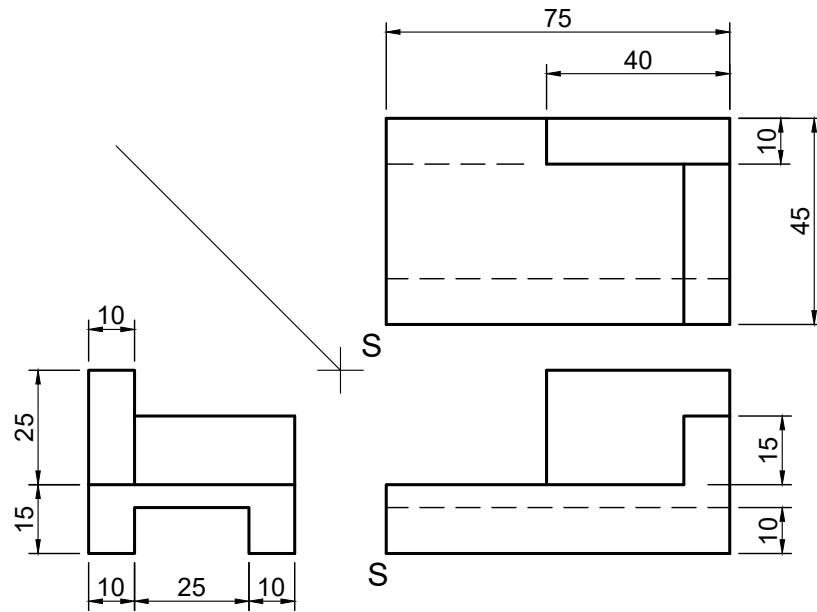

S

ASSESSMENT CRITERIA			
1	START POSITION	2	
2	BASE	7.5	
3	UPRIGHT PART	7	
PENALTIES (1)			
SUBTOTAL		16.5	

QUESTION 3: ISOMETRIC

Given:

The front view, top view and left view of a casting.
The position of point Q on the diagram sheet.

Instructions:

Use a scale of 1 : 1 and convert the orthographic views of the casting into an isometric drawing.

- Make Q the lowest point of the drawing.
- Show all necessary constructions.
- NO hidden detail is required.

[13,5]

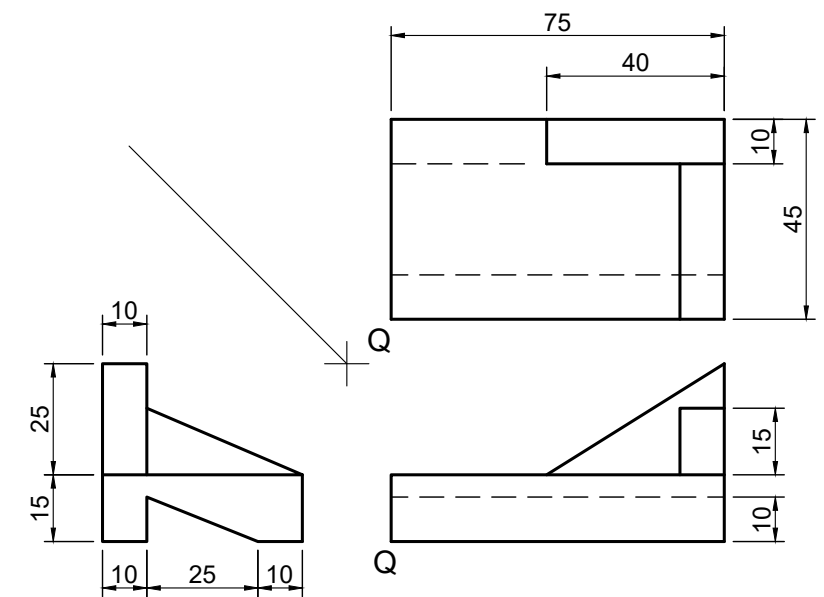

Q

ASSESSMENT CRITERIA			
1	START POSITION	2	
2	BASE	7.5	
3	UPRIGHT PART	4	
PENALTIES (-)			
SUBTOTAL		13.5	
GRANT TOTAL		30	



ISOMETRIC DRAWING

ESTIMATED TIME FOR COMPLETION
YOUR TIME OF COMPLETION

20 MIN
MIN

GRADE
10

NAME &
SURNAME

TASK
6.1

PAGE
34