

QUESTION 2.1: SOLID GEOMETRY

Given:

- The front view of an equilateral pentagonal pyramid.
- The base side length of the equilateral pentagonal pyramid is 22 mm.

Instructions:

Draw to a scale of 1 : 1, the following views of the solid:

- 2.1 The given front view
- 2.2 The top view
- 2.3 The right view

Note:

- Planning is essential.
- Show all construction lines.
- Show all hidden detail.

| ASSESSMENT CRITERIA | | | | |
|---------------------|------------|-----------|--|--|
| 1 | RIGHT VIEW | 12 | | |
| 2 | FRONT VIEW | 6 | | |
| 3 | TOP VIEW | 5 | | |
| PENALTIES (-1) | | | | |
| TOTAL | | 23 | | |

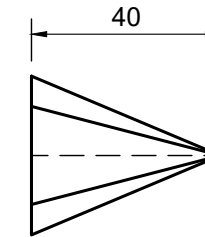

QUESTION 2.2: SOLID GEOMETRY

Given:

- The front view of an equilateral pentagonal pyramid.
- The base side length of the equilateral pentagonal pyramid is 25 mm.

Instructions:

Draw to a scale of 1 : 1, the following views of the solid:

- 2.1 The given front view
- 2.2 The top view
- 2.3 The right view

Note:

- Planning is essential.
- Show all construction lines.
- Show all hidden detail.

| ASSESSMENT CRITERIA | | | | |
|---------------------|------------|-----------|--|--|
| 1 | RIGHT VIEW | 12 | | |
| 2 | FRONT VIEW | 6 | | |
| 3 | TOP VIEW | 5 | | |
| PENALTIES (-1) | | | | |
| TOTAL | | 23 | | |

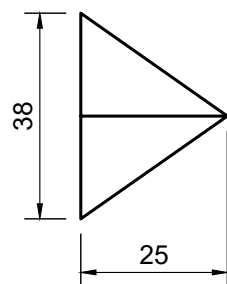

QUESTION 2.3: SOLID GEOMETRY

Given:

- The front view of an equilateral hexagonal pyramid.
- The across distance at the base, from side to side of the equilateral hexagonal pyramid is 38 mm.

Instructions:

Draw to a scale of 1 : 1, the following views of the solid:

- 2.1 The given front view
- 2.2 The top view
- 2.3 The right view

Note:

- Planning is essential.
- Show all construction lines.

| ASSESSMENT CRITERIA | | | | |
|---------------------|------------|-----------|--|--|
| 1 | RIGHT VIEW | 10 | | |
| 2 | FRONT VIEW | 4 | | |
| 3 | TOP VIEW | 6 | | |
| PENALTIES (-1) | | | | |
| TOTAL | | 20 | | |

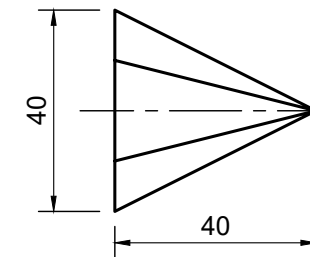

QUESTION 2.4: SOLID GEOMETRY

Given:

- The front view of an equilateral hexagonal pyramid.
- The distance at the base, from corner to corner of the equilateral hexagonal pyramid is 40 mm.

Instructions:

Draw to a scale of 1 : 1, the following views of the solid:

- 2.1 The given front view
- 2.2 The top view
- 2.3 The left view

Note:

- Planning is essential.
- Show all construction lines.
- Show all hidden detail.

| ASSESSMENT CRITERIA | | | | |
|---------------------|------------|-----------|--|--|
| 1 | TOP VIEW | 10 | | |
| 2 | FRONT VIEW | 6 | | |
| 3 | LEFT VIEW | 4 | | |
| PENALTIES (-1) | | | | |
| TOTAL | | 20 | | |



SOLID GEOMETRY

ESTIMATED TIME FOR COMPLETION

30 MIN

GRADE

10

NAME & SURNAME

TASK

7.12

PAGE

2.12