

ROOM DESIGNATIONS & FLOOR FINISHING
 ROOM 1: ABLUTION FACILITY TILES
 ROOM 2: BATHROOM TILES
 ROOM 3: TOILET TILES
 ROOM 4: SHOWER TILES

ELECTRICAL SYMBOLS		
NUMBER	SYMBOL	DESCRIPTION
1		SINGLE POLE SWITCH
2		DOUBLE POLE SWITCH
3		TRIPLE POLE SWITCH
4		CEILING MOUNTED LIGHT
5		WALL MOUNTED LIGHT
6		2 X 40 W FLUORESCENT LIGHTS
7		SWITCH SOCKET OUTLET
8		DISTRIBUTION BOARD

NOTE: REPLACE EACH NUMBER ON THE FLOOR PLAN WITH THE CORRESPONDING SYMBOL AS INDICATED AT THE END POINTS. MAKE USE OF A FREEHAND LINE TO REPRESENT THE ELECTRICAL CABLE TO JOIN THE DIFFERENT COMPONENTS WITH EACH OTHER.

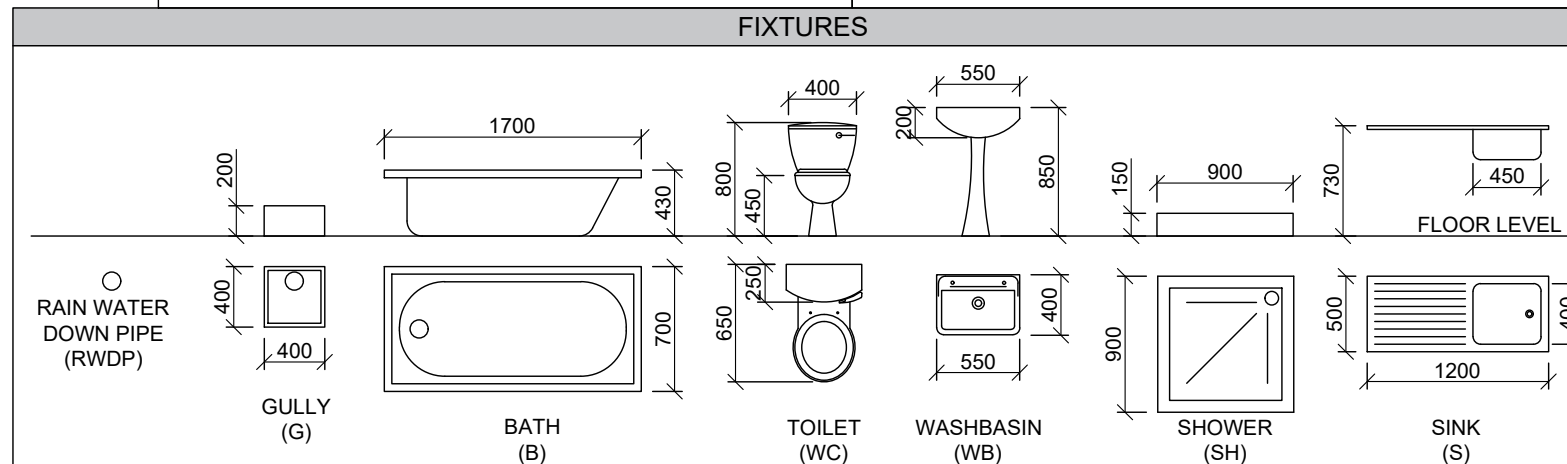
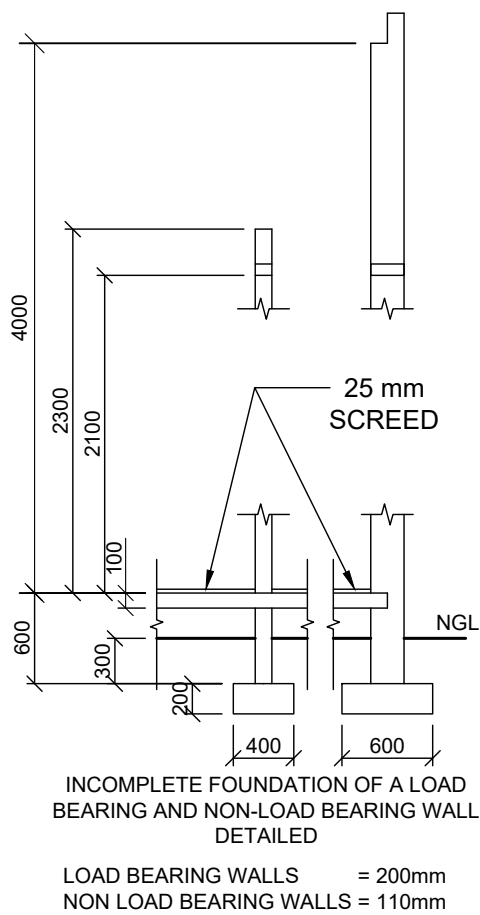

DOOR AND WINDOW SCHEDULE

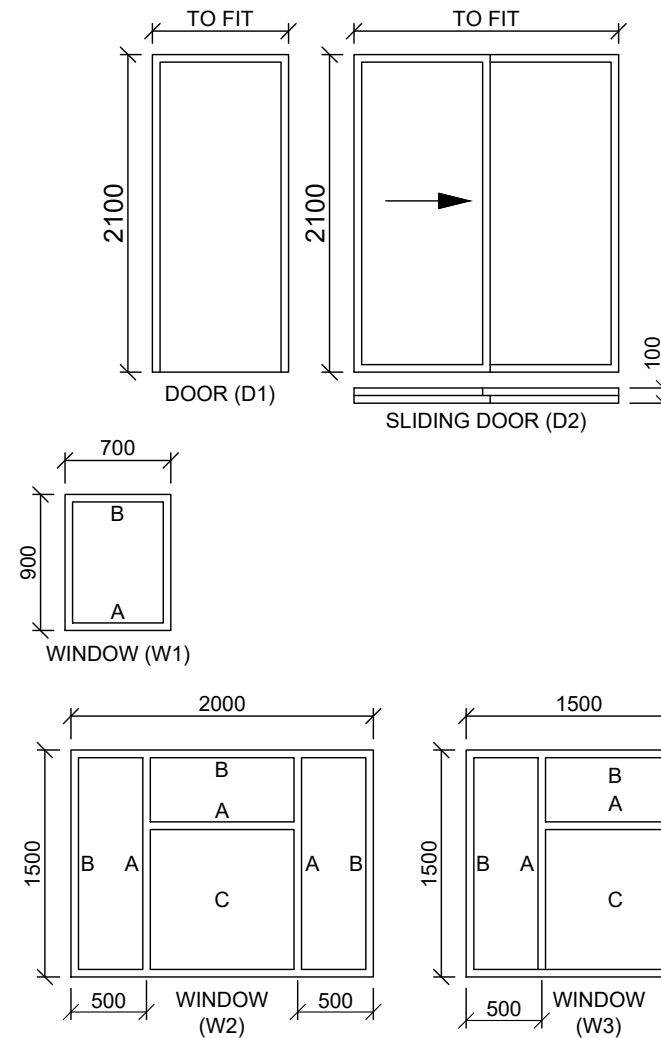

DOOR AND WINDOW NOTES:

- A = OPENING SIDE
- B = HINGED SIDE
- C = FIXED PANEL
- 150 x 20 mm FIBRE CEMENT SILL (30°) UNDER ALL WINDOWS
- 200 x 75 mm LINTEL ABOVE ALL DOOR & WINDOW OPENINGS
- ALL LINTELS ARE AT THE SAME HEIGHT
- ALL FRAMES 50mm THICK

QUESTION 4: CIVIL DRAWING

Given:

- The incomplete floor plan showing the walls, position of the doors, windows, fixtures and electrical layout
- The incomplete north elevation showing the walls, window openings and roof
- The incomplete foundation and external wall detail
- Room designations and floor finishes
- A door and window schedule
- A table of electrical features
- A table of features and fixtures
- The incomplete floor plan and north elevation of the ablution facility, drawn to scale 1 : 50 and the incomplete foundation, roof detail and break line of the detailed section view, drawn to scale 1 : 20 on page 4.9.

Instructions:

Answer this question on page 4.9.

4.1 Use the given incomplete floor plan, incomplete elevation view and incomplete section view and draw, in first-angle orthographic projection and to a **required scale**, the following views of the ablution facility:

4.1.1 THE COMPLETE FLOOR PLAN.

Add the following features to the drawing:

- ALL doors and windows
- ALL electrical symbols and connection detail as indicated on the diagram sheet.
- ALL hatching detail.

4.1.2 THE COMPLETE NORTH ELEVATION.

Show the following features on the drawing:

- The outside walls, door detail and window detail
- The natural ground level and finished floor level

4.2 Use the incomplete wall detail and break of continuity lines on page 80 and draw, to **scale 1 : 20**, a detailed section view on **cutting plane C-C** of the area in the ellipse shown on the incomplete floor plan.

Show the following features on the drawing:

- The complete detail of the foundation and wall
- ALL hatching detail. Only the substructure hatching may be drawn in neat free hand

Label the following:

- The appropriate title and scale of each view
- The room designations and floor finishes
- Ground level, finished floor level and damp prove coarse as abbreviations on all relevant views

NOTE:

- ALL drawings must comply with the guidelines and graphical symbols as contained in the *SANS 10143*. [90]



CIVIL

ESTIMATED TIME FOR COMPLETION 40 MIN
 YOUR TIME FOR COMPLETION MIN

GRADE 10

INITIALS & SURNAME

TASK 11.2
 PAGE 5.6

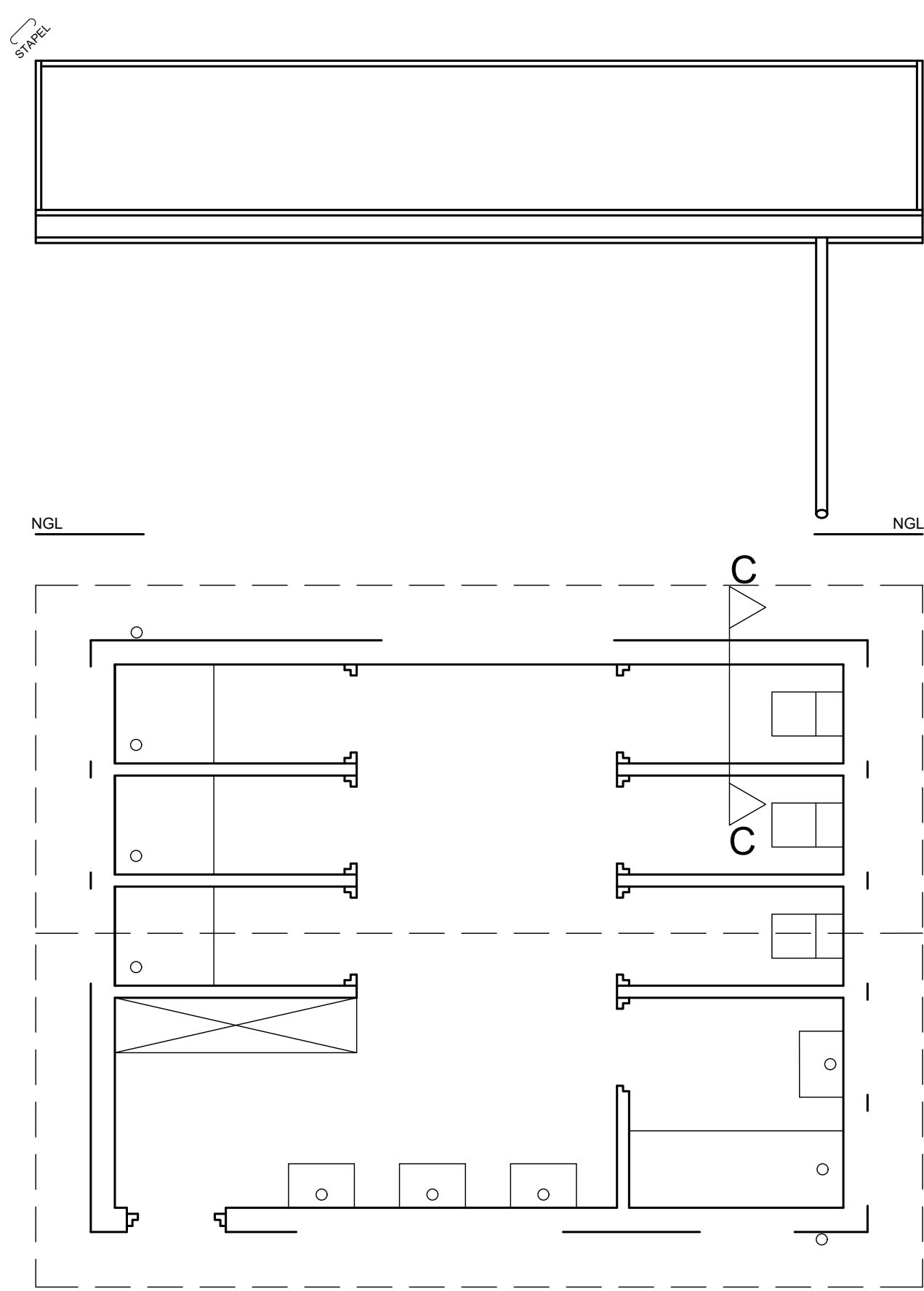

PENALIZING FOR OFFICE USE ONLY	
INCORRECT SCALE(S) USED	-2
NON-ALIGNMENT OF VIEWS	-2
VIEW(S) ROTATED	-2
SECTION VIEWED INCORRECTLY	-2
INCORRECT LETTERING	-1
TOTAL	

ASSESSMENT CRITERIA			
FLOOR PLAN			
1	DOORS + WINDOWS	30.5	
2	ELECTRICAL SYMBOLS	11	
3	HATCHING	4	
4	LABELS	9	
SUB TOTAL 1		54.5	
NORTH ELEVATION			
1	WALLS + FFL + NGL	2	
2	DOOR + WINDOW	11.5	
3	LABELS	1	
SUB TOTAL 2		14.5	
DETAILED SECTION			
1	FOUNDATION + WALL + SLAB	12	
2	HATCHING	6	
3	LABELS	3	
SUB TOTAL 3		21	
TOTAL		90	
TOTAL PENALTIES (-)			
GRAND TOTAL			



CIVIL WORK DRAWING

ESTIMATED TIME FOR COMPLETION 40 MIN
YOUR TIME FOR COMPLETION MIN

MIN

GRADE 10

INITIALS & SURNAME

TASK 11.2

PAGE 5.7