

QUESTION 3: PERSPECTIVE

Given:

Three views of a shaped block with the information needed to draw a one-point perspective drawing. The front view is not drawn to the correct position for the final completion of the drawing.

The explanation for the abbreviations are as follow:

- PP - Picture plane
- HL - Horizon line
- GL - Ground Line
- SP - Station point

Instructions:

- Use the given information and draw a one-point-perspective drawing.
- Determine and label the vanishing point.
- Show all construction lines.
- No hidden detail is required.
- Marks will be deducted for inaccuracy and untidiness. **[11]**

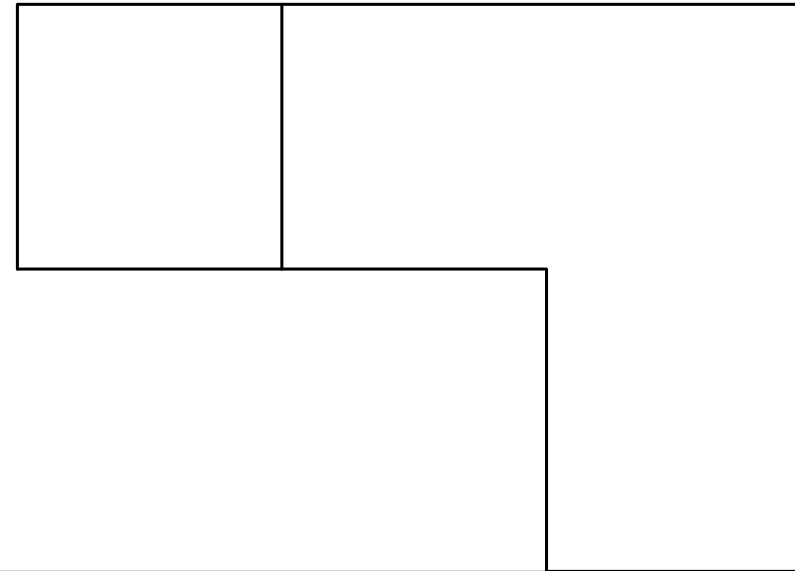

ASSESSMENT CRITERIA				
1	CONSTRUCTION	4		
2	ARCS	7		
PENALTIES (-)				
TOTAL		11		

PP

PP

HL

HL

GL

GL

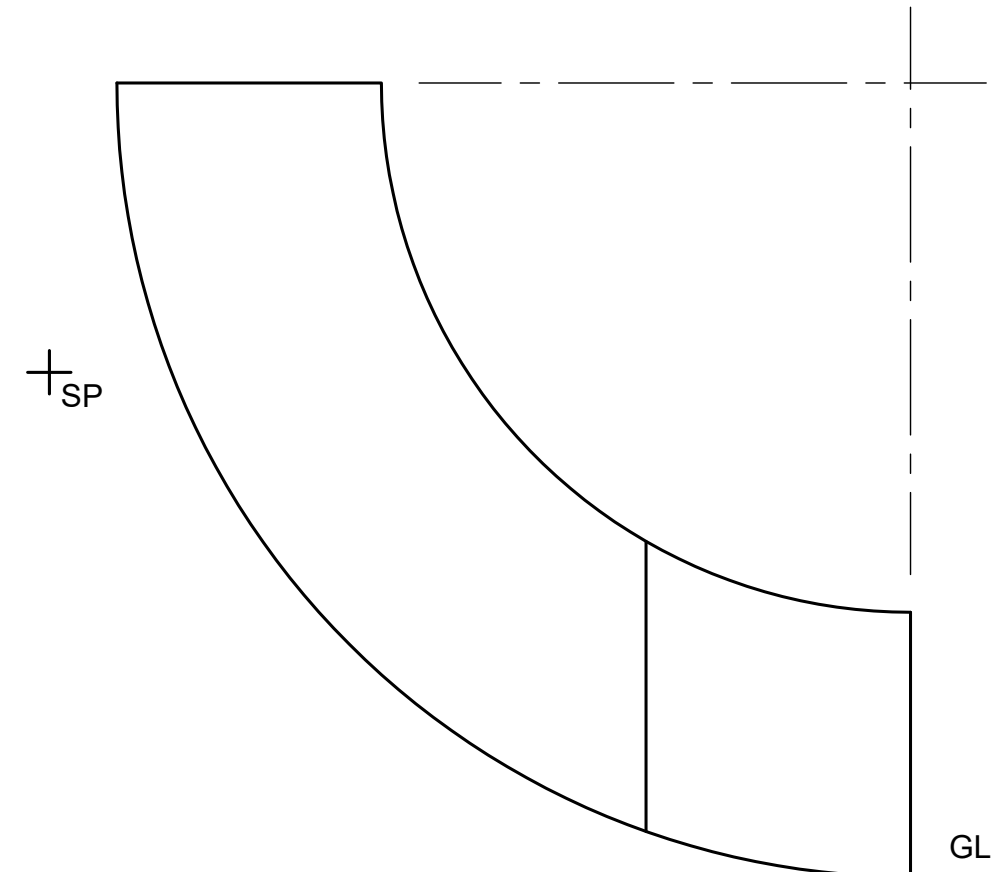
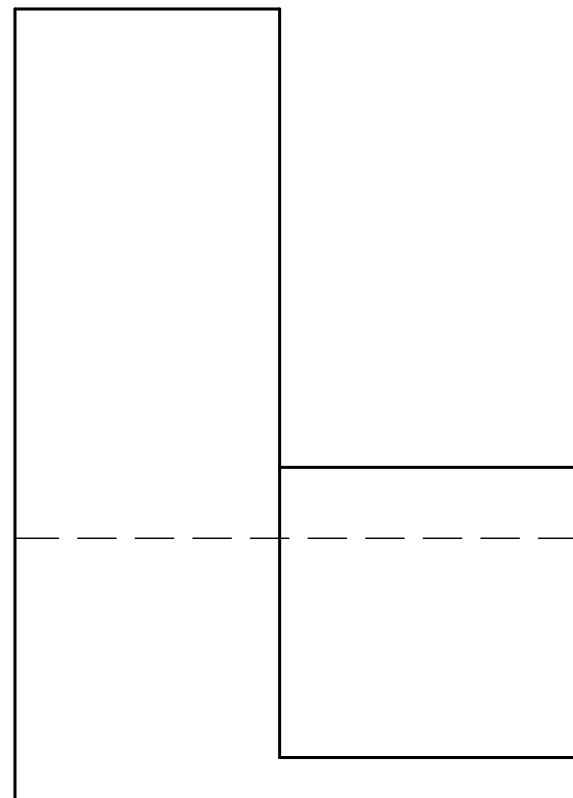

ONE-POINT-PERSPECTIVE

ESTIMATED TIME FOR COMPLETION

30 MIN

GRADE

10

NAME & SURNAME

TASK
12.9

PAGE
4.9

YOUR TIME OF COMPLETION

MIN