

INCOMPLETE NORTH VIEW

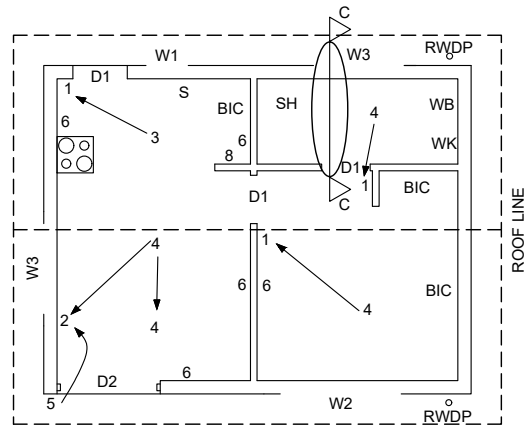

INCOMPLETE FLOOR PLAN

ELECTRICAL FITTINGS

1. ONE-WAY SWITCH - SINGLE POLE
2. ONE-WAY SWITCH - DOUBLE POLE
3. 2 x 40W - FLUORESCENT LIGHT
4. CEILING LIGHT
5. WALL-MOUNTED LIGHT
6. SWITCH SOCKET OUTLET
7. SOCKET OUTLET
8. DISTRIBUTION BOARD

NOTE:
THE ARROW SHOWS THE LIGHT CONNECTION TO THE SWITCH.

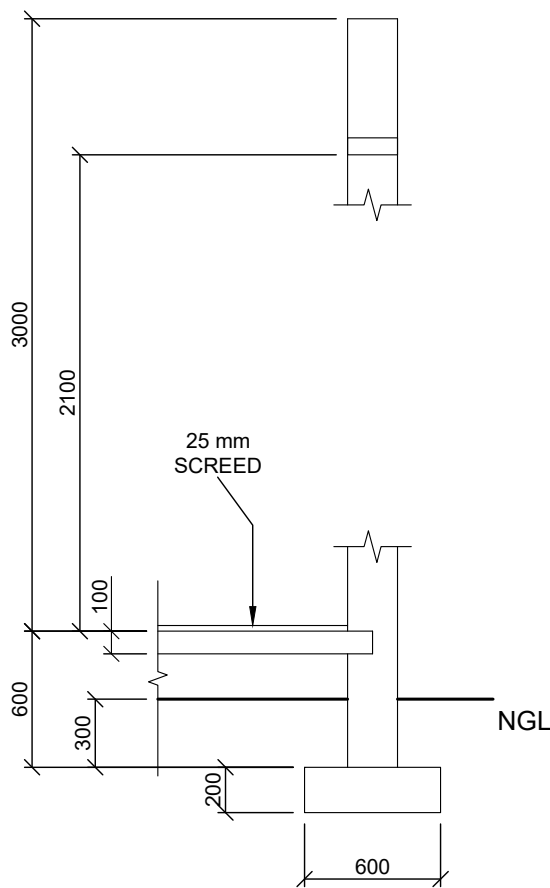
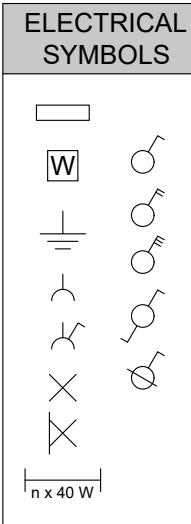

INCOMPLETE FOUNDATION AND EXTERNAL WALL DETAILED

LOAD BEARING WALLS = 200mm
NON LOAD BEARING WALLS = 110mm

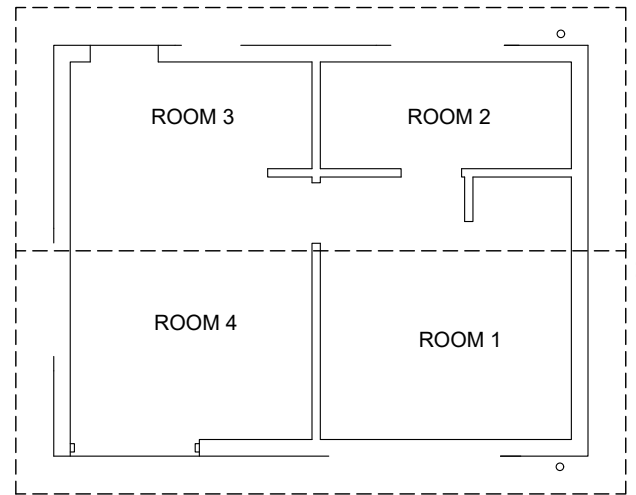

ROOM DESIGNATION

ROOM DESIGNATIONS AND FLOOR FINISHING

- | | |
|------------------|--------|
| ROOM 1: BEDROOM | CARPET |
| ROOM 2: BATHROOM | TILES |
| ROOM 3: KITCHEN | TILES |
| ROOM 4: LOUNGE | TILES |

DOOR AND WINDOW SCHEDULE

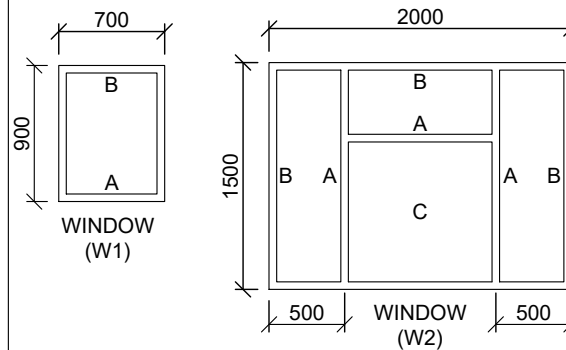
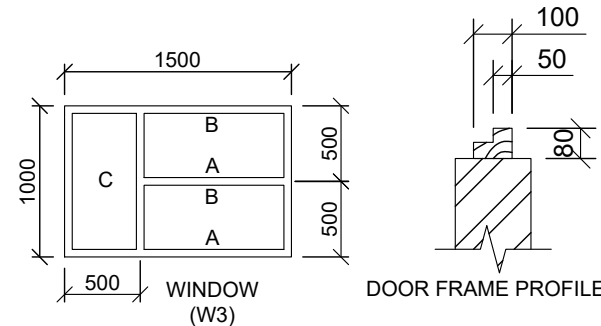
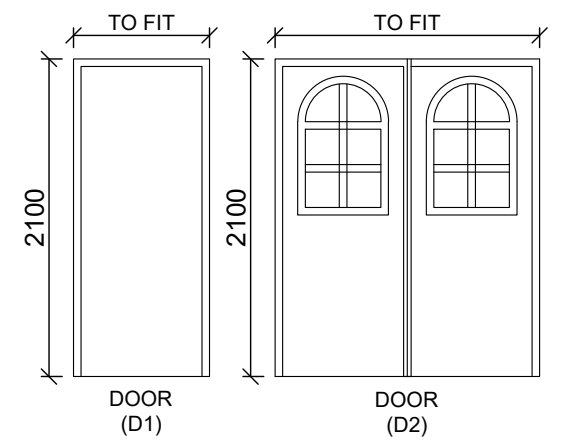

DOOR AND WINDOW NOTES:

- A = OPENING SIDE
- B = HINGED SIDE
- C = FIXED PANEL
- 150 x 20 mm FIBRE CEMENT SILL (30°) UNDER ALL WINDOWS
- 2 LINTELS of 100 mm x 75 mm ABOVE ALL DOOR & WINDOW OPENINGS
- ALL LINTELS ARE AT THE SAME HEIGHT
- ALL FRAMES 50mm THICK

FIXTURES

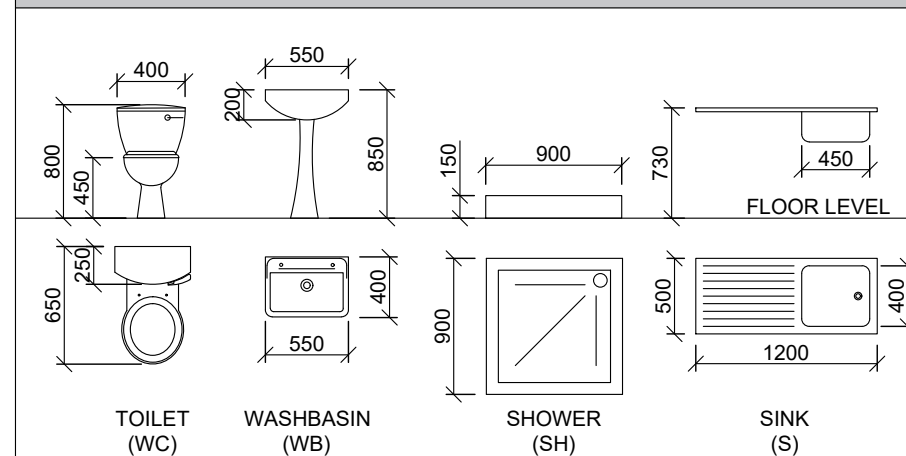

QUESTION 4: CIVIL DRAWING

Given:

- The incomplete north elevation of a house showing the walls, the door and window openings, the roof and notes.
- The incomplete floor plan showing the walls, positions of the doors, windows, fixtures and the electrical layout.
- The incomplete detail of the foundation and walls.
- The rainwater down-pipe detail.
- Room designations and floor finishes.
- A table of electrical symbols.
- A door and window schedule.
- A table of fixtures.
- The incomplete floor plan of the new house, drawn to scale 1 : 50 and the incomplete foundation and break line of the detailed section, drawn to scale 1 : 20.

Instructions:

Answer these questions as follow.

4.1 Using the given incomplete floor plan, draw, in first-angle orthographic projection and to a scale 1 : 50, the following views of the new house:

4.1.1 THE COMPLETE FLOOR PLAN.

Add the following features to the drawing:

- ALL doors and windows.
- ALL fixtures as indicated by abbreviations.
- ALL electrical fittings as indicated by the numbers.
- ALL hatching detail.

4.1.2 THE COMPLETE NORTH ELEVATION.

Show the following features on the drawing:

- The outside walls, door and window detail.
- The finished floor level.

4.2 Using the incomplete foundation and break line and draw, to scale 1:20, a **DETAILED SECTION VIEW** on cutting plane C-C of the area in the ellipse shown on the incomplete floor plan.

Show the following features on the drawing:

- The complete detail of the foundation and walls
- ALL hatching detail. ONLY the substructure hatching may be drawn in neat free hand.
- The door detail.

Label the following:

- Each view and indicate the scale used.
- The room designations and floor finishes.
- Ground level, finished floor level and damp-proof course (use the correct abbreviations and show them on ALL the relevant views).

NOTE:

- ALL drawings must comply with the guidelines and graphical symbols as contained in the SANS 10143. [85]

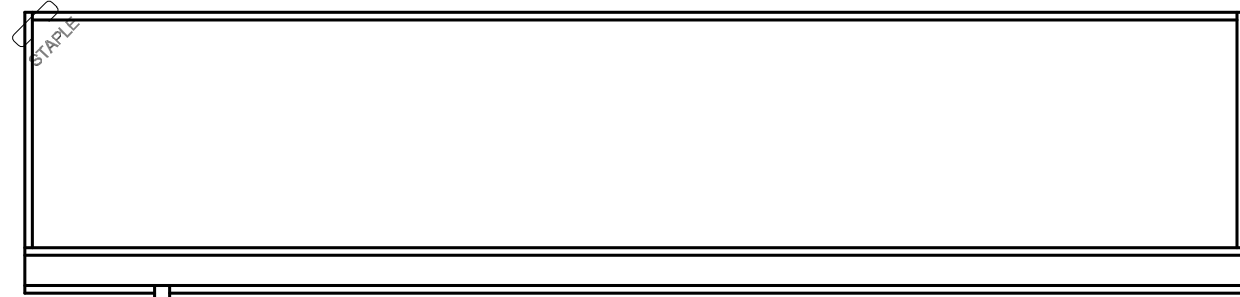

NGL

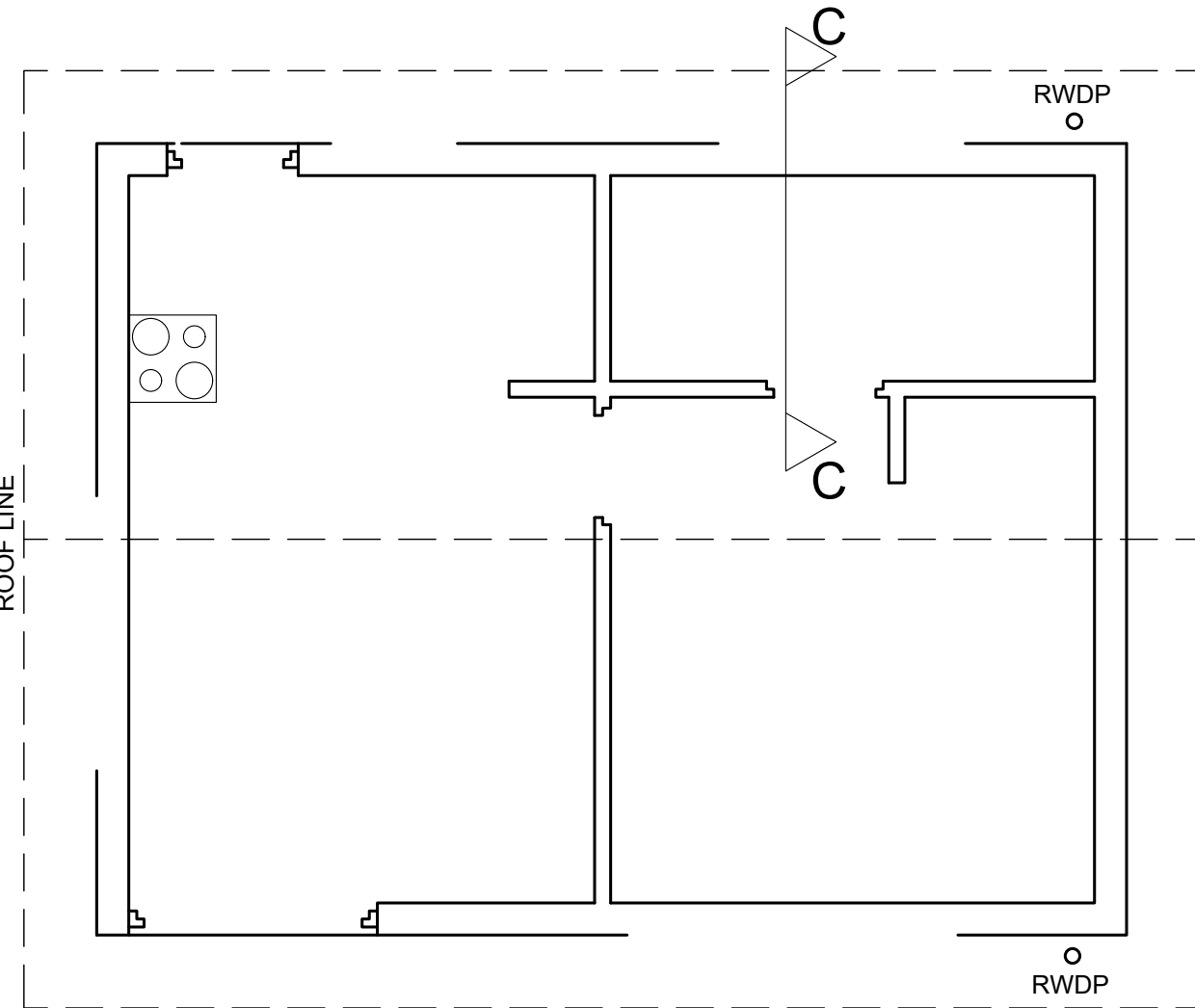

ROOF LINE

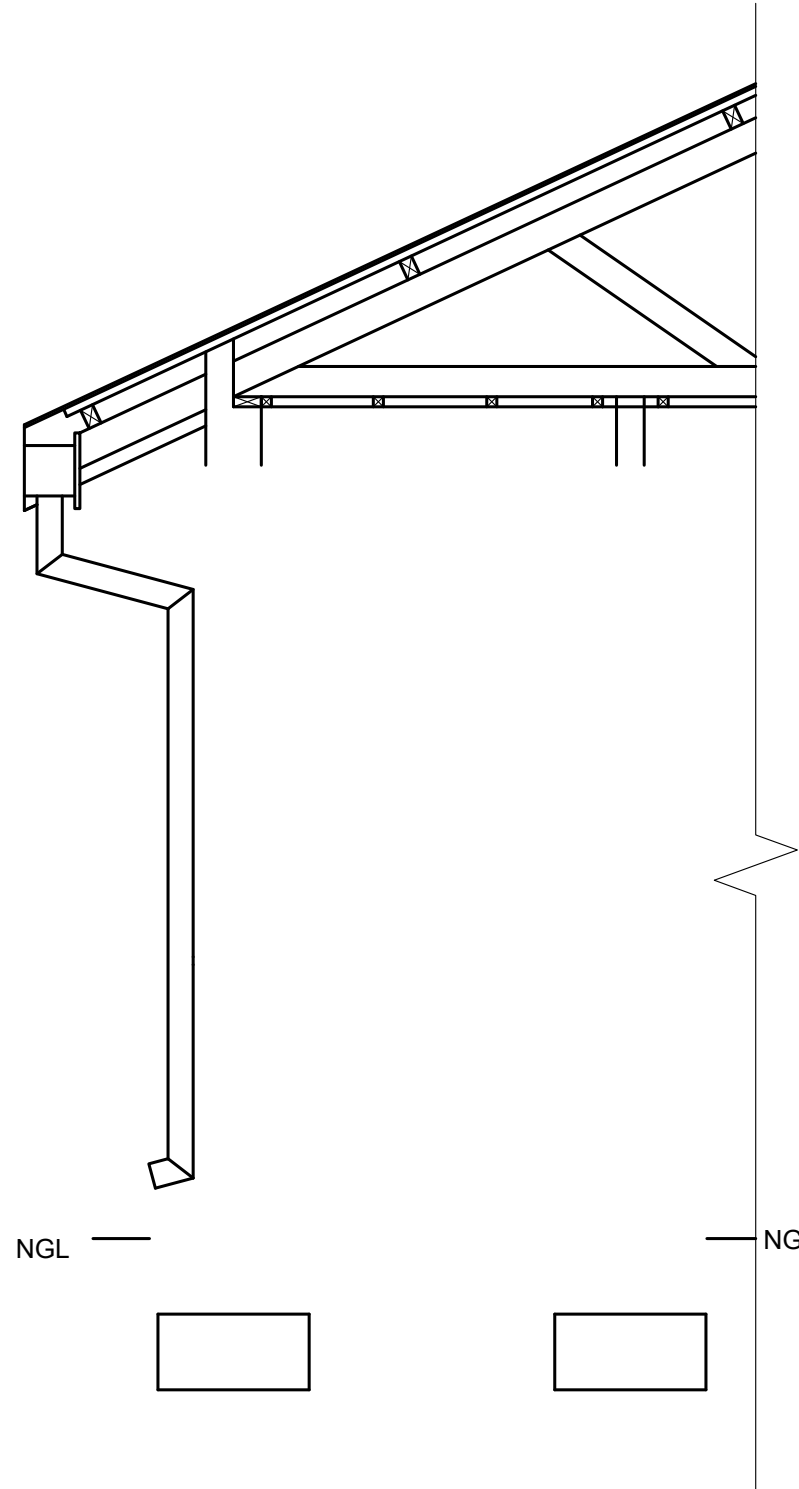

NGL

NGL

FOR OFFICIAL USE ONLY	
INCORRECT SCALE	-2
NON-ALIGNMENT OF VIEWS	-2
VIEW(S) ROTATED	-2
SECTION VIEWED INCORRECTLY	-2
INCORRECT LETTERING	-1
TOTAL	

ASSESSMENT CRITERIA				
FLOOR PLAN				
1	DOORS + WINDOWS	14		
2	FIXTURES	11		
3	ELECTRICAL	11		
4	HATCHING	4		
5	LABELS	5		
SUB TOTAL 1		45		
NORTH ELEVATION				
1	WALLS + FFL	2		
2	DOOR + WINDOW	11		
3	LABELS	1		
SUB TOTAL 2		14		
DETAILED SECTION				
1	FOUNDATION + WALL + SLAB + DOOR + LINTEL	11.5		
2	FIXTURES	4		
3	HATCHING	8.5		
4	LABELS	2		
SUB TOTAL 3		26		
TOTAL		85		
TOTAL PENALTIES (-)				
GRAND TOTAL				



CIVIL ELEVATION AND SECTION VIEW	ESTIMATED TIME FOR COMPLETION	40 MIN	GRADE 11	NAME & SURNAME		TASK 6.2	PAGE 24
	YOUR TIME OF COMPLETION	MIN					