

Grade 11 CIVIL PAT (Floor plan)

Developed by: PC Viljoen
Senior Educational Specialist for
Engineering Graphics and Design
Free State Province

A CIVIL TITLE BLOCK

- The PAT floor plan should be drawn on the prepared civil name block drawing sheet
- See term 1, week 9 information:
- 11.1.9.3.1 PAT Preparation of drawing sheets
- 11.1.9,3,2 Civil and Mechanical Title Block examples

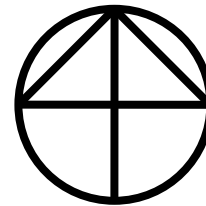

Notes:

1. All windows should be steel.
2. Roof coverage should be tiles
3. All dimensions not shown should be consulted with architect
4. Etc.

Copyright stamp:

Blackey Swart
&
Whitey Whitehead
Architects Ltd
P.O Box 1001
Zebra View Valley
2001

Date print issued:

2016-02-25

Architect/ Engineer/ Planner

J Smuts

Project

Project Title:

Rural Health Development

Drawing Title:

Zebra Health Clinic

Project No:

DoH 071

Drawing No:

5

Code ref.

Dep. of Health

Scale

1:200

Date

2016/02/28

Drawn

V Mabe

Checked

P Nomo

PRESCRIBED CONTENT FOR GRADE 12 PAT

- Determine the correct scale to fit the drawing

VLOERPLAN
FLOOR PLAN
SKAAL 1:50
SCALE 1:50

Notes:
1. All windows should be double glazed.
2. Roof coverage should be tiles
3. All dimensions not shown should be consulted with architect
4. Etc.

Copyright stamp:
Blackey Swart & Whitey Whitehead Architects Ltd
P.O Box 1001
Zebra View Valley
2001

Date print issued:
2016-02-25

Architect/ Engineer/ Planner
J Smuts

Project

Project Title:
Rural Health Development

Drawing Title:
Zebra Health Clinic

Project No:
DoH 071

Drawing No:

Code ref.
Dep. of Health

Scale 1:200	Date 2016/02/28	Drawn V Mabe	Checked P Nomo
----------------	--------------------	-----------------	-------------------

education
Department of Education
FREE STATE PROVINCE

PRESCRIBED CONTENT FOR GRADE 10, 11 & 12

- The floor plan will be evaluated on the following:

6	Show on the FLOOR PLAN:				
6.1	All internal and external walls.	2			
6.2	All windows.	2			
6.3	The doors and direction of door openings.	2			
6.4	All sanitary kitchen and other permanent fixtures.	2			
6.5	Labels, notes and annotations of...				

FLOOR PLAN

- The walls of a house can be
 - load bearing (220mm)
 - or
 - non-load bearing (110mm)

FOUNDATION DIMENSIONS

- **Load bearing walls (220 mm wide)**

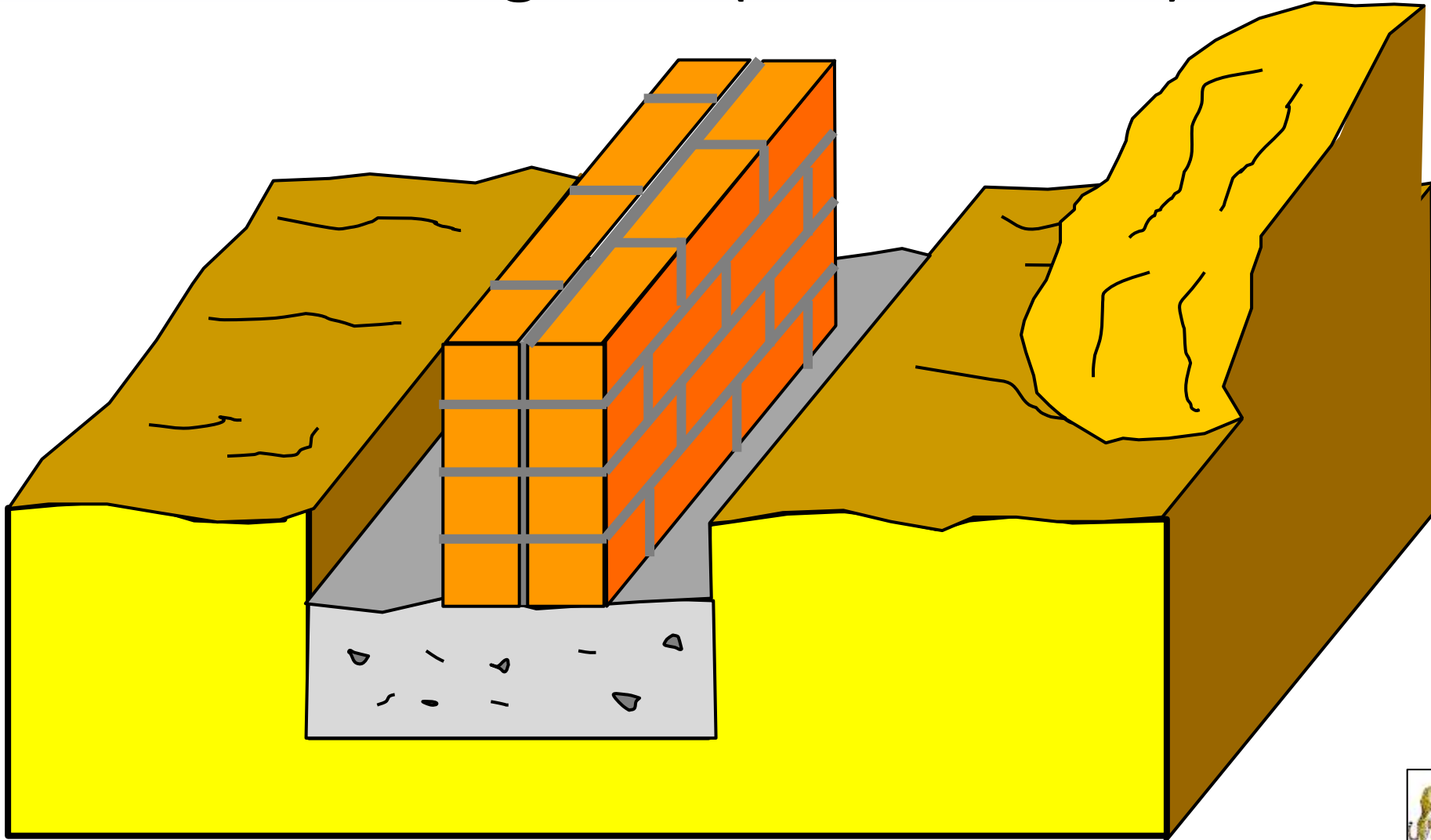

FLOOR PLAN

- Load bearing walls (220 mm wide)

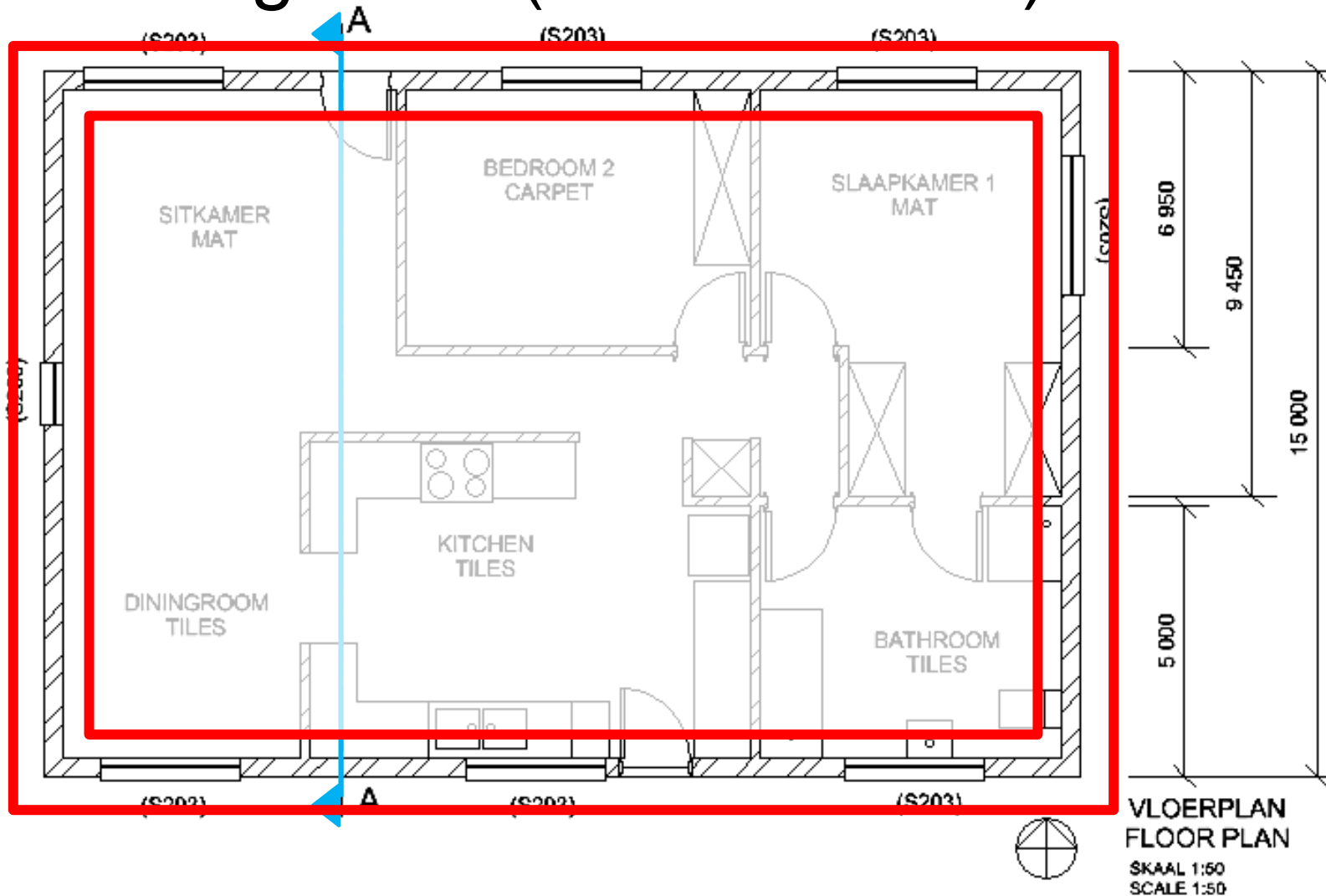

FOUNDATION DIMENSIONS

- **Non load bearing walls (110 mm wide)**

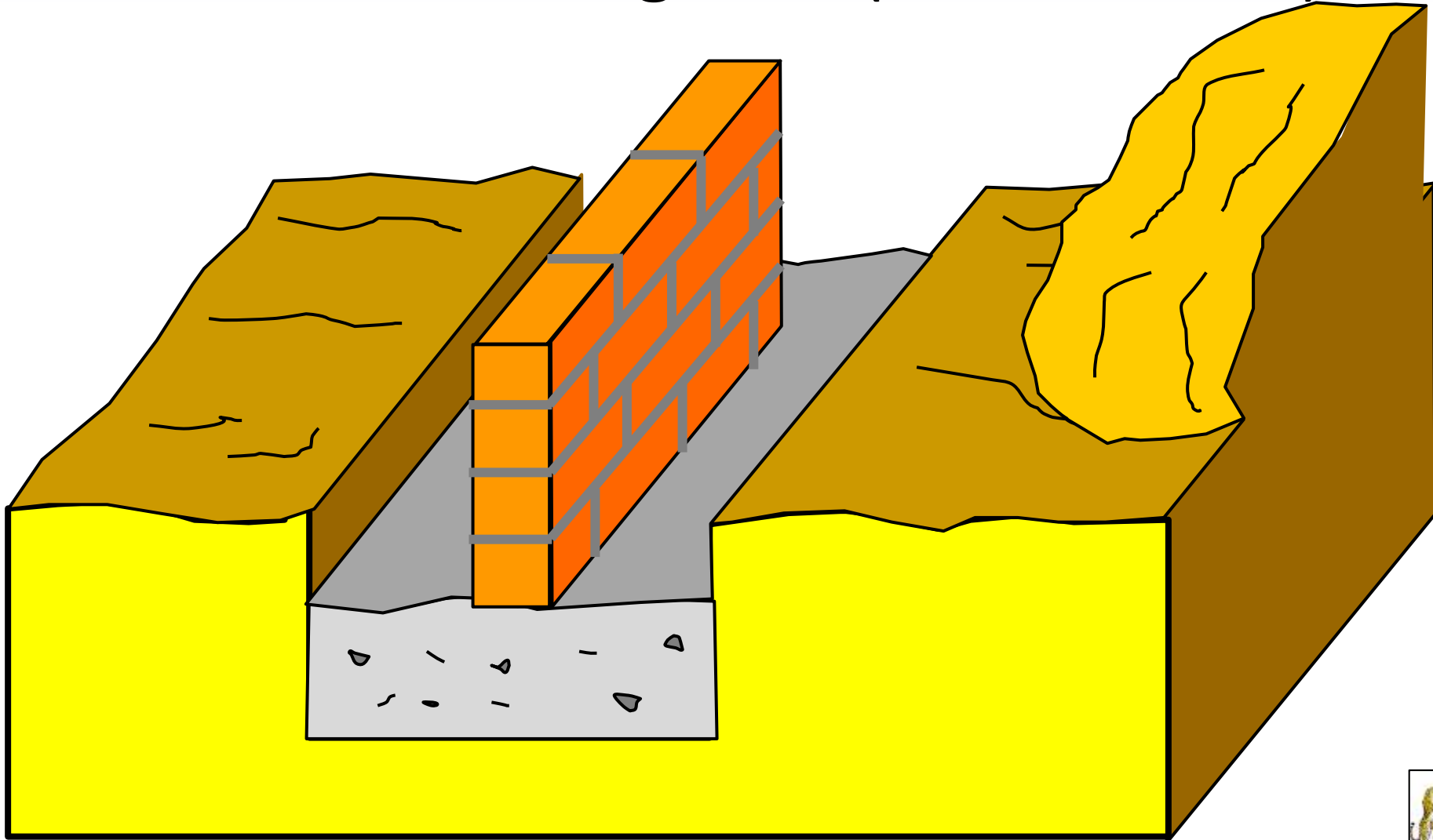

FLOOR PLAN

- Non load bearing walls (110 mm wide)

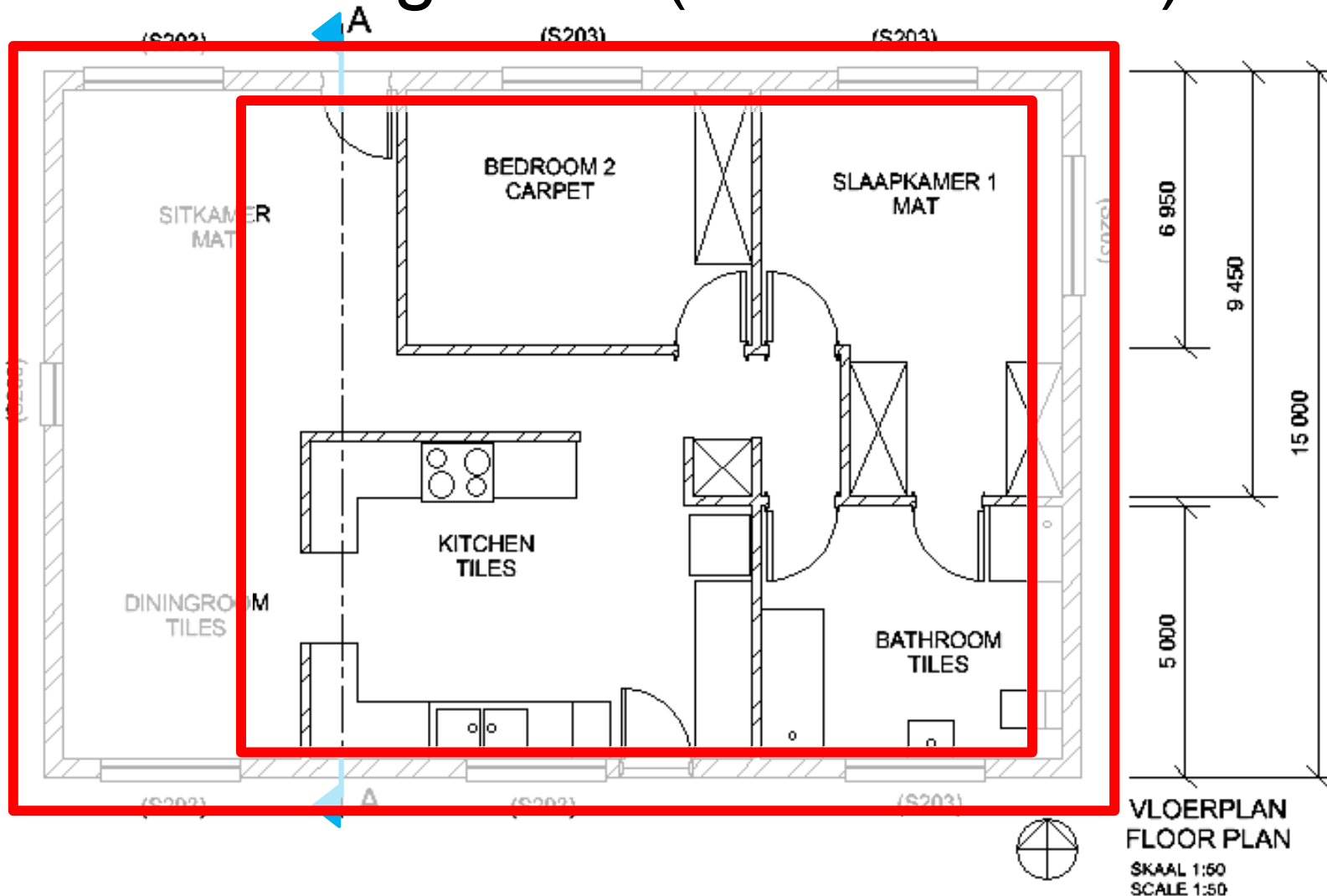

VLOERPLAN
FLOOR PLAN
SKAAL 1:50
SCALE 1:50

PRESCRIBED CONTENT FOR GRADE 10, 11 & 12

- The floor plan will be evaluated on the following:

6	Show on the FLOOR PLAN:				
6.1	All internal and external walls.	2			
6.2	All windows.	2			
6.3	The doors and direction of door openings.	2			
6.4	All sanitary kitchen and other permanent fixtures.	2			
6.5	Labels, notes and annotations of...				

PRESCRIBED CONTENT FOR GRADE 10, 11 & 12

- The floor plan showing the windows and doors.

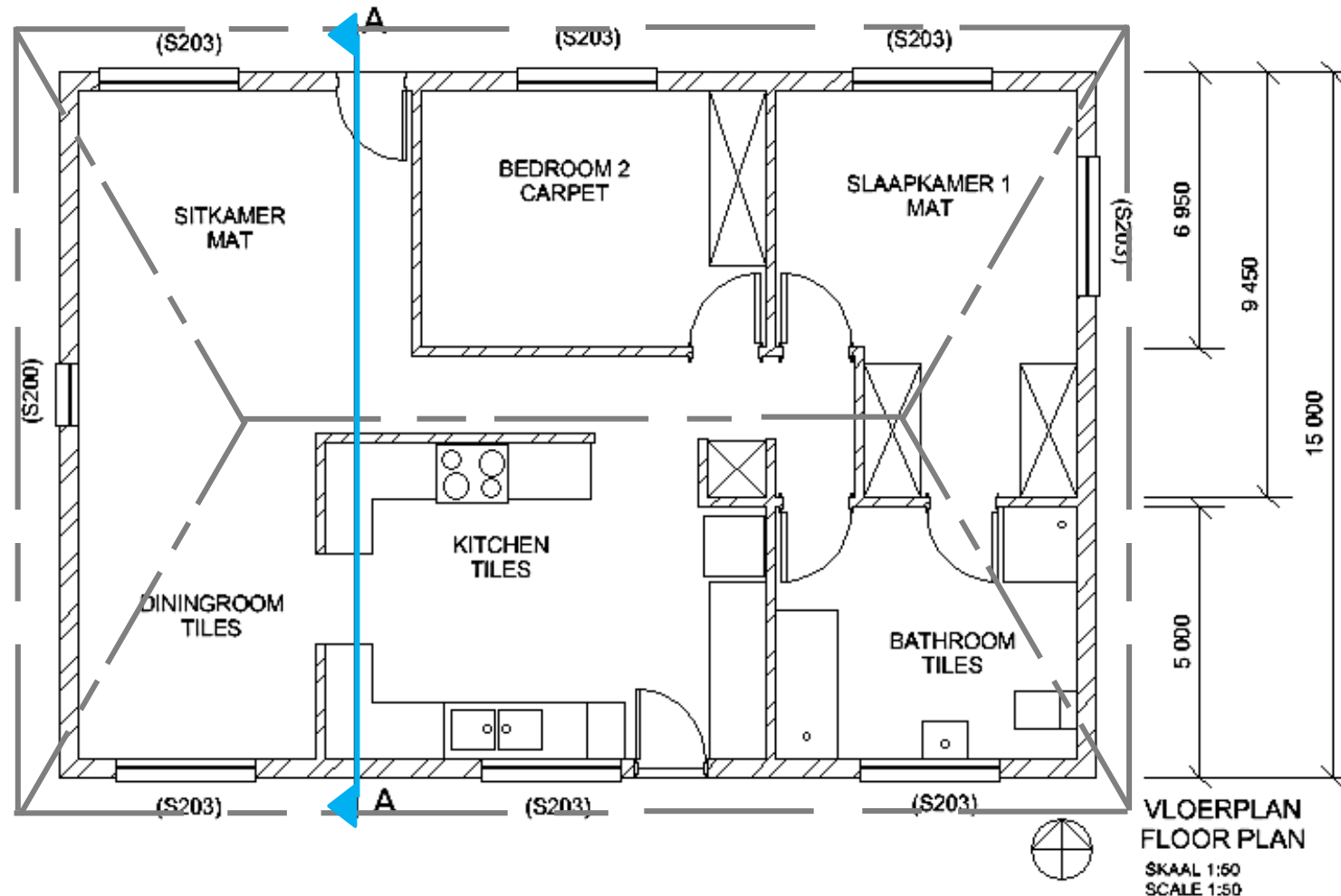

WINDOWS ARE AVAILABLE IN DIFFERENT SHAPES & SIZES

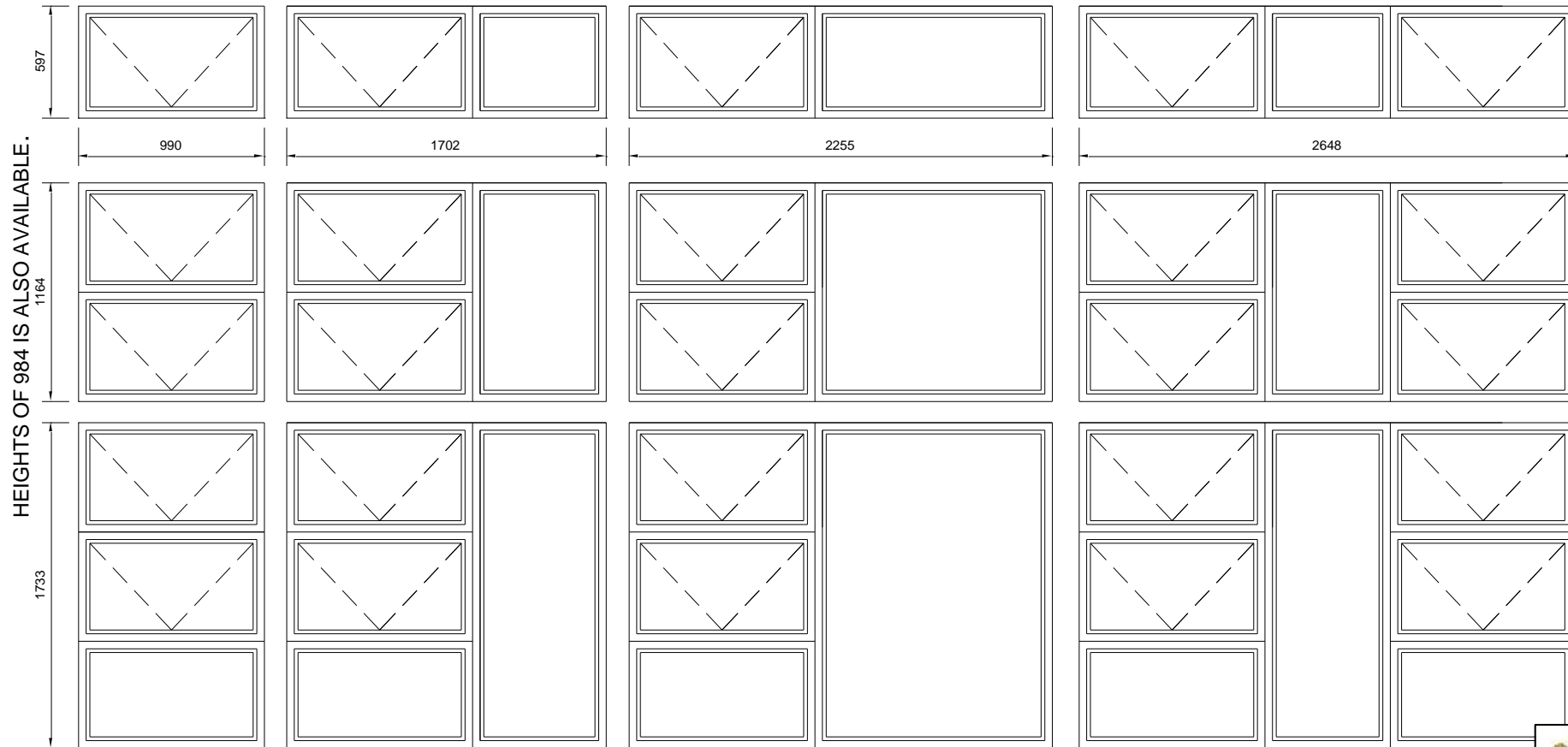

WIDTHS OF 3200 IS ALSO AVAILABLE.

FLOOR PLAN

- Drawing a window with a window sill and according to scale

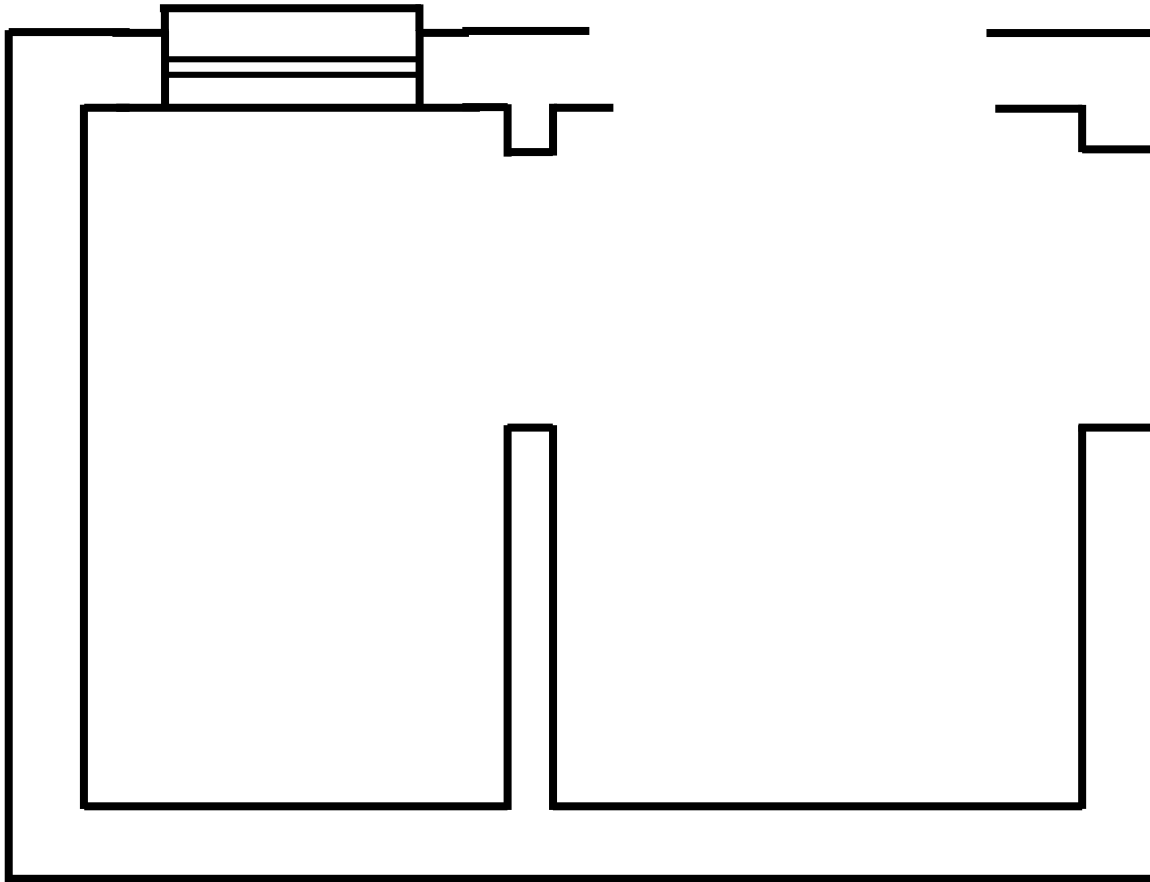

FLOOR PLAN

- Label all windows according to window codes

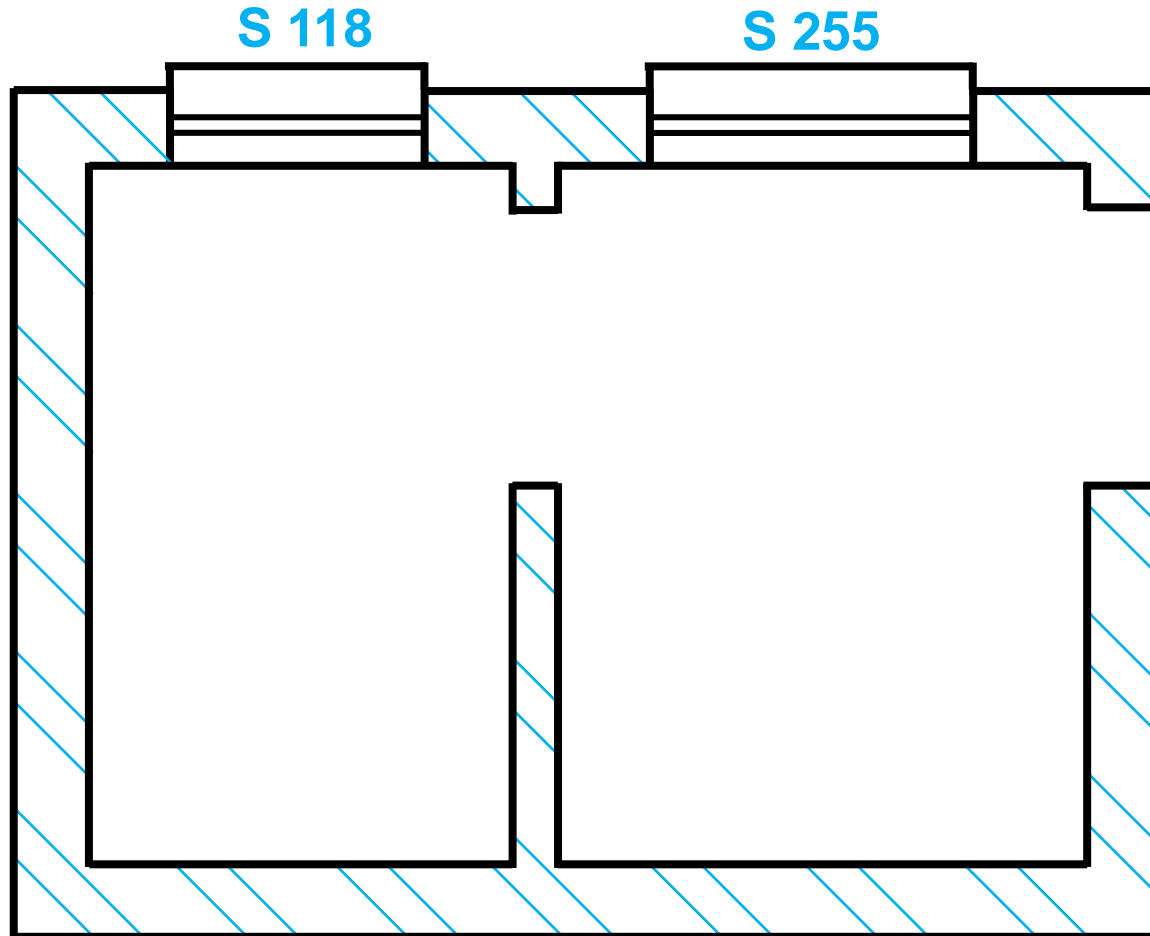

FLOOR PLAN

- The windows of a house

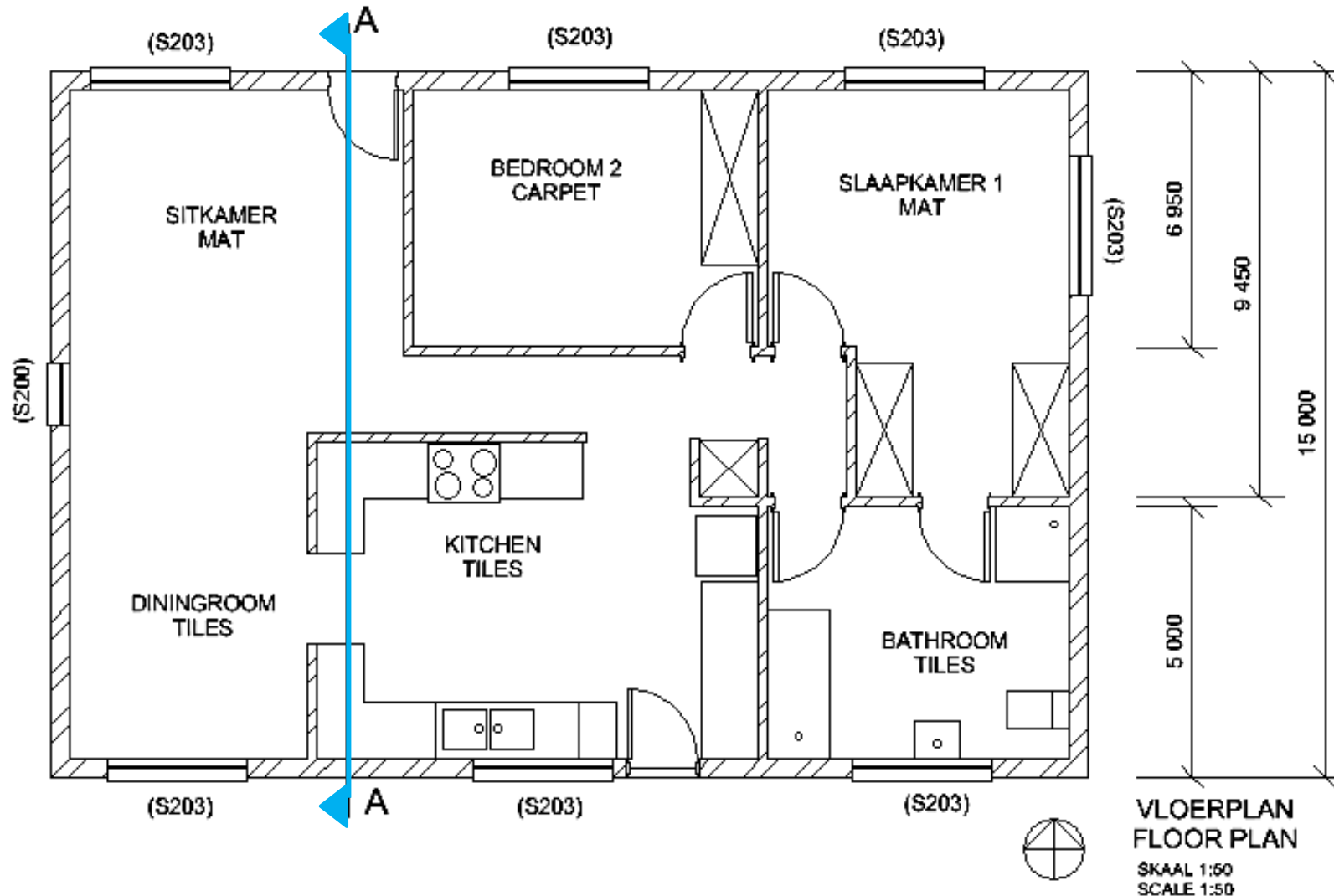

PRESCRIBED CONTENT FOR GRADE 10, 11 & 12

- The floor plan will be evaluated on the following:

6	Show on the FLOOR PLAN:				
6.1	All internal and external walls.	2			
6.2	All windows.	2			
6.3	The doors and direction of door openings.	2			
6.4	All sanitary kitchen and other permanent fixtures.	2			
6.5	Labels, notes and annotations of...				

FLOOR PLAN

- Interior & exterior door openings.

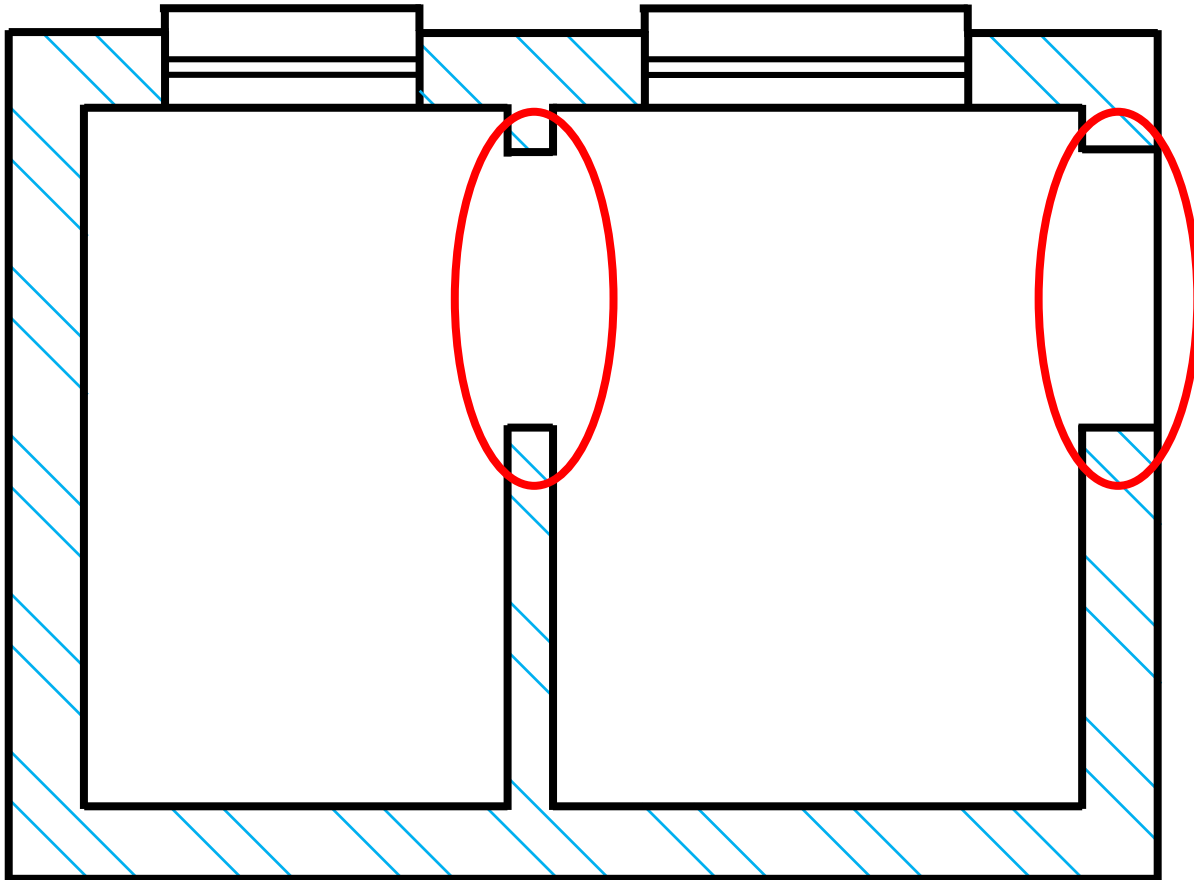

FLOOR PLAN

- Exterior garage door openings.

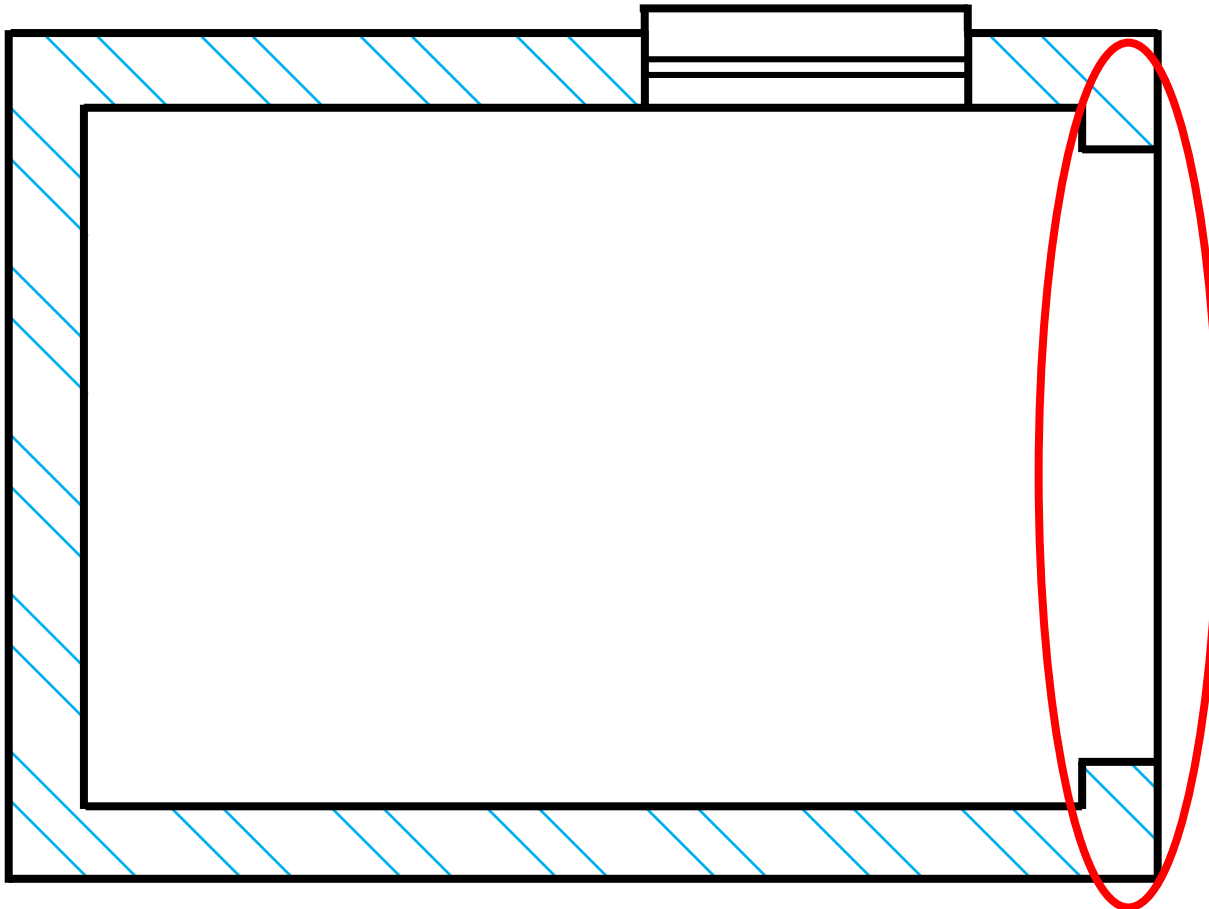

FLOOR PLAN

- The doors of a house

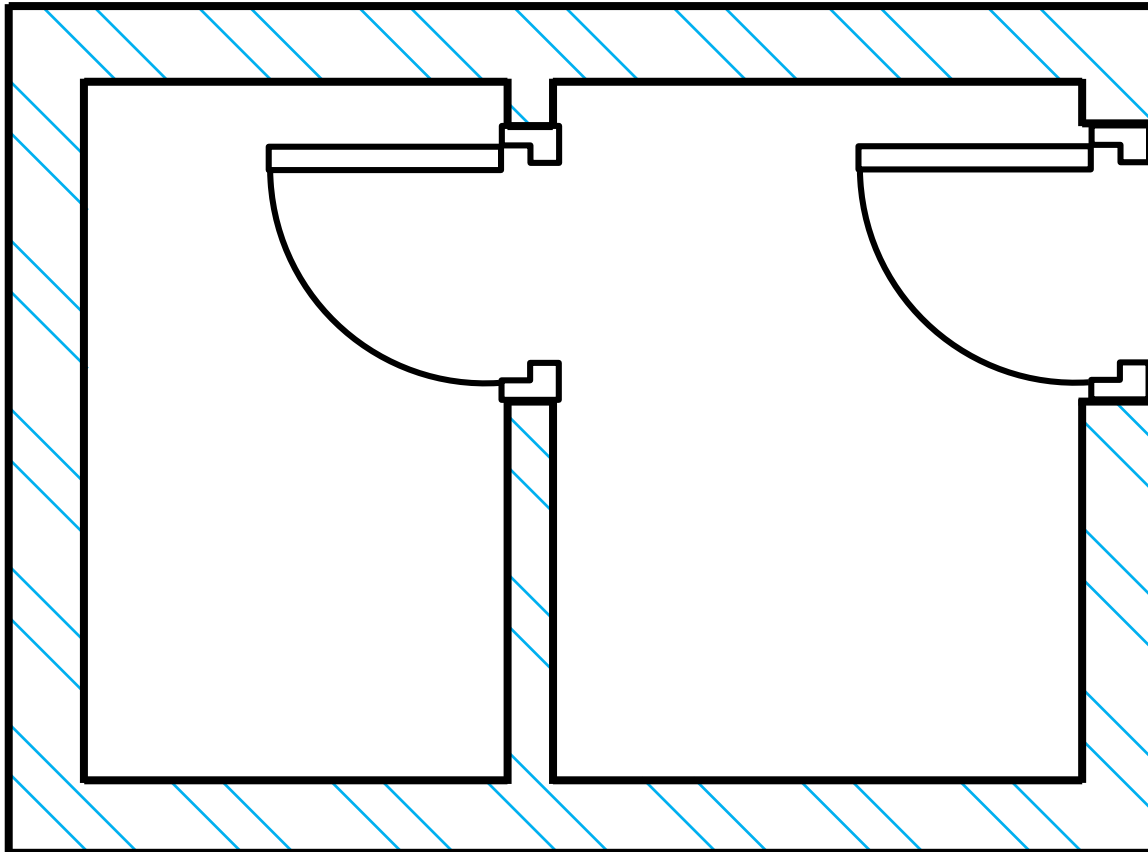

FLOOR PLAN

- The door frames of a house can be manufactured from...
 - Wood
 - Steel or
 - Aluminum

FLOOR PLAN

- Wooden doors frame

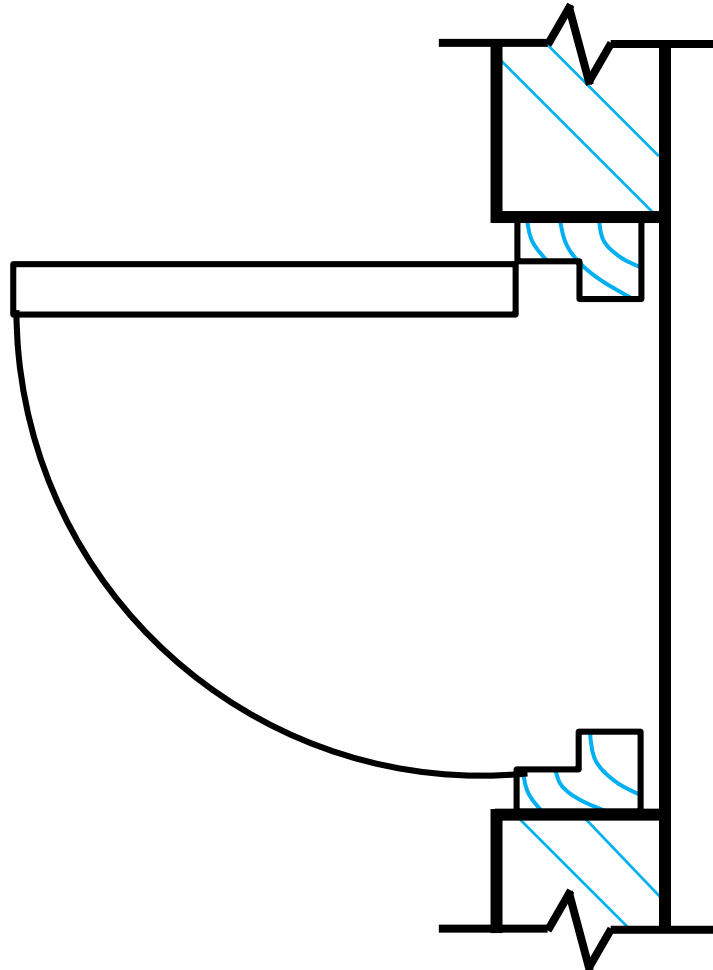

FLOOR PLAN

- Steel doors frame

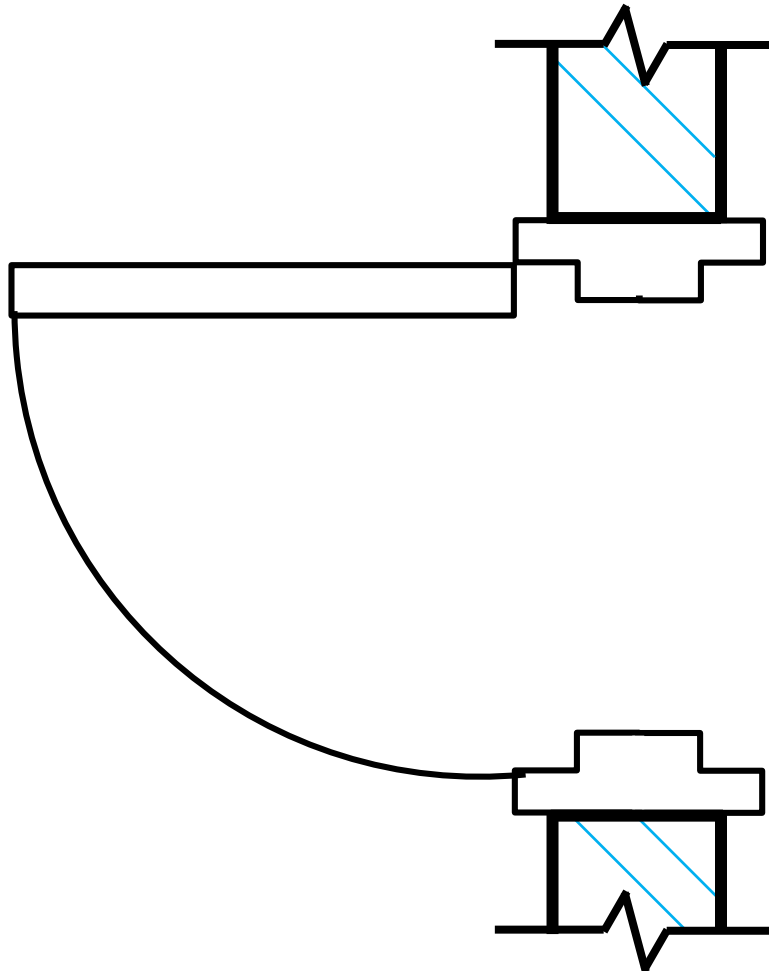

FLOOR PLAN

- Aluminum door frame (option 1)
 - The arrow indicate the sliding direction of the door.

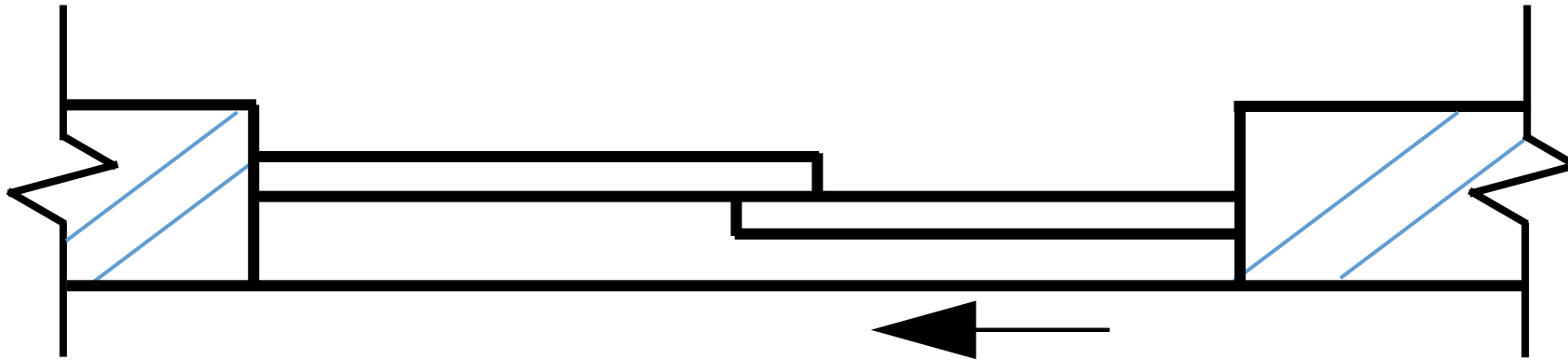

FLOOR PLAN

- Aluminum door frame (option 2)
 - The arrow indicate the sliding direction of the door.

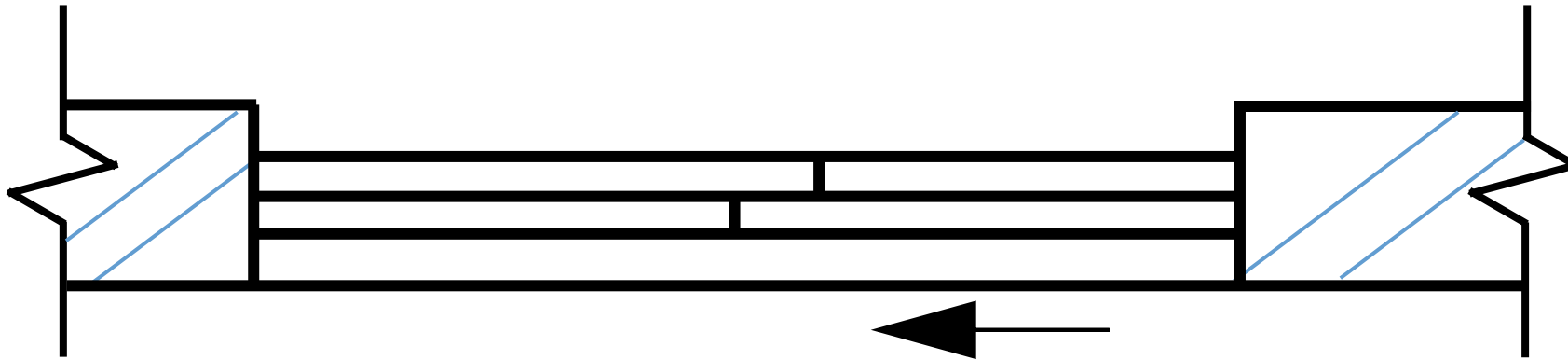

FLOOR PLAN

- All door openings (functionality & privacy)

