

Grade 11 CIVIL PAT (Annotation)

Developed by: PC Viljoen
Senior Educational Specialist for
Engineering Graphics and Design
Free State Province

PRESCRIBED CONTENT FOR GRADE 10, 11 & 12

- The floor plan will be evaluated on the following:

6.5	Labels, notes and annotations of...				
6.5.1	The room designations .	1			
6.5.2	The floor coverage of each room.	1			
6.5.3	Outer dimensions of the house.	2			
6.5.4	The cutting plane cutting through a door, non-load bearing wall and a window.	2			

Gothic Printing

- The style of lettering that is used in all disciplines of engineering drawings should be done according to the SANS Codes of Practice
 - **SANS 10111** for Engineering drawings
 - **SANS 10134** for building drawings

Gothic Printing

A B C D E F G H I J K L M N

O P Q R S T U V W X Y Z

0 1 2 3 4 5 6 7 8 9

Gothic Printing

ALWAYS DRAW GUIDELINES

BEFORE YOU START WITH

ANNOTATION

Gothic Printing

ALWAYS USE UPPER CASE

ANNOTATION UNLES

OTHERWISE STATED

TITLE

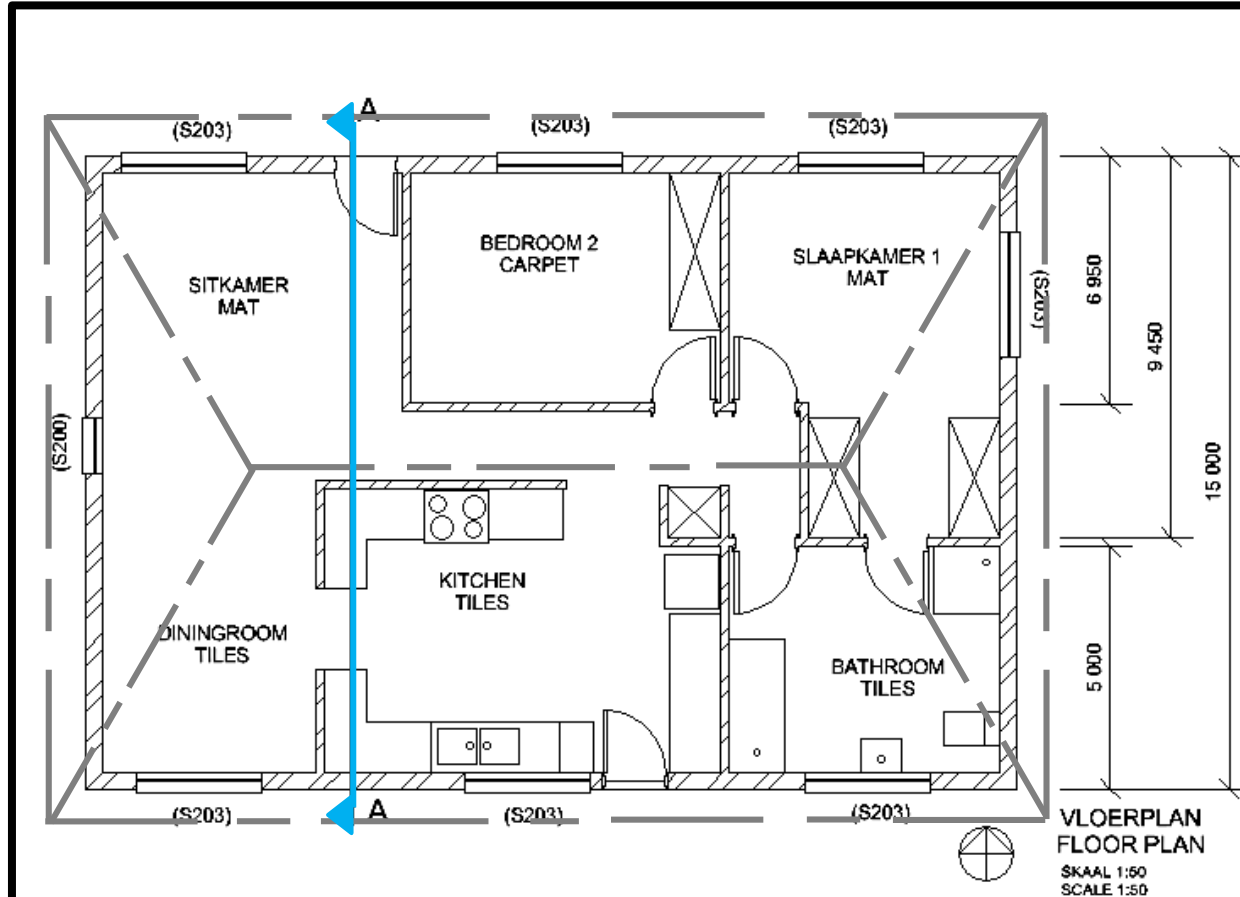

Notes:

1. All windows should be steel.
2. Roof coverage should be tiles
3. All dimensions not shown should be consulted with architect
4. Etc.

Copyright stamp:



Date print issued:

2016-02-25

Architect/ Engineer/ Planner

J Smuts

Project

Project Title:

Rural Health Development

Drawing Title:

Zebra Health Clinic

Project No:

DoH 071

Drawing No:

5

Code ref.

Dep. of Health

Scale

1:200

Date

2016/02/28

Drawn

V Mabe

Checked

P Nomo



PRESCRIBED CONTENT FOR GRADE 10, 11 & 12

- The floor plan will be evaluated on the following:

6.5	Labels, notes and annotations of...				
6.5.1	The room designations .	1			
6.5.2	The floor coverage of each room.	1			
6.5.3	Outer dimensions of the house.	2			
6.5.4	The cutting plane cutting through a door, non-load bearing wall and a window.	2			

LABELS

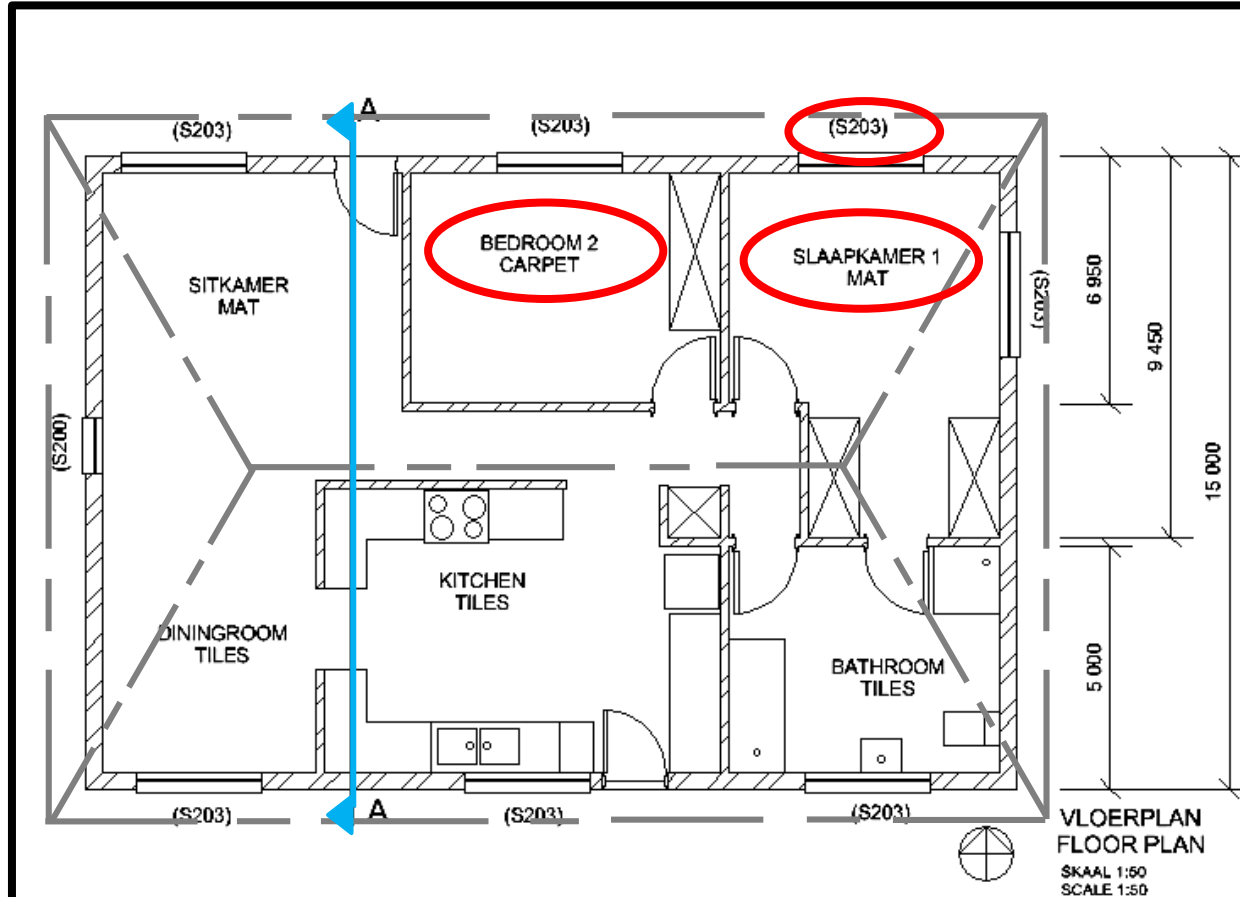

Notes:

1. All windows should be steel.
2. Roof coverage should be tiles
3. All dimensions not shown should be consulted with architect
4. Etc.

Copyright stamp:

Blackey Swart
&
Whitey Whitehead
Architects Ltd
P.O Box 1001
Zebra View Valley
2001

Date print issued:

2016-02-25

Architect/ Engineer/ Planner

J Smuts

Project

Project Title:

Rural Health Development

Drawing Title:

Zebra Health Clinic

Project No:

DoH 071

Drawing No:

Code ref.

Dep. of Health

5

Scale

1:200

Date

2016/02/28

Drawn

V Mabe

Checked

P Nomo

NOTES

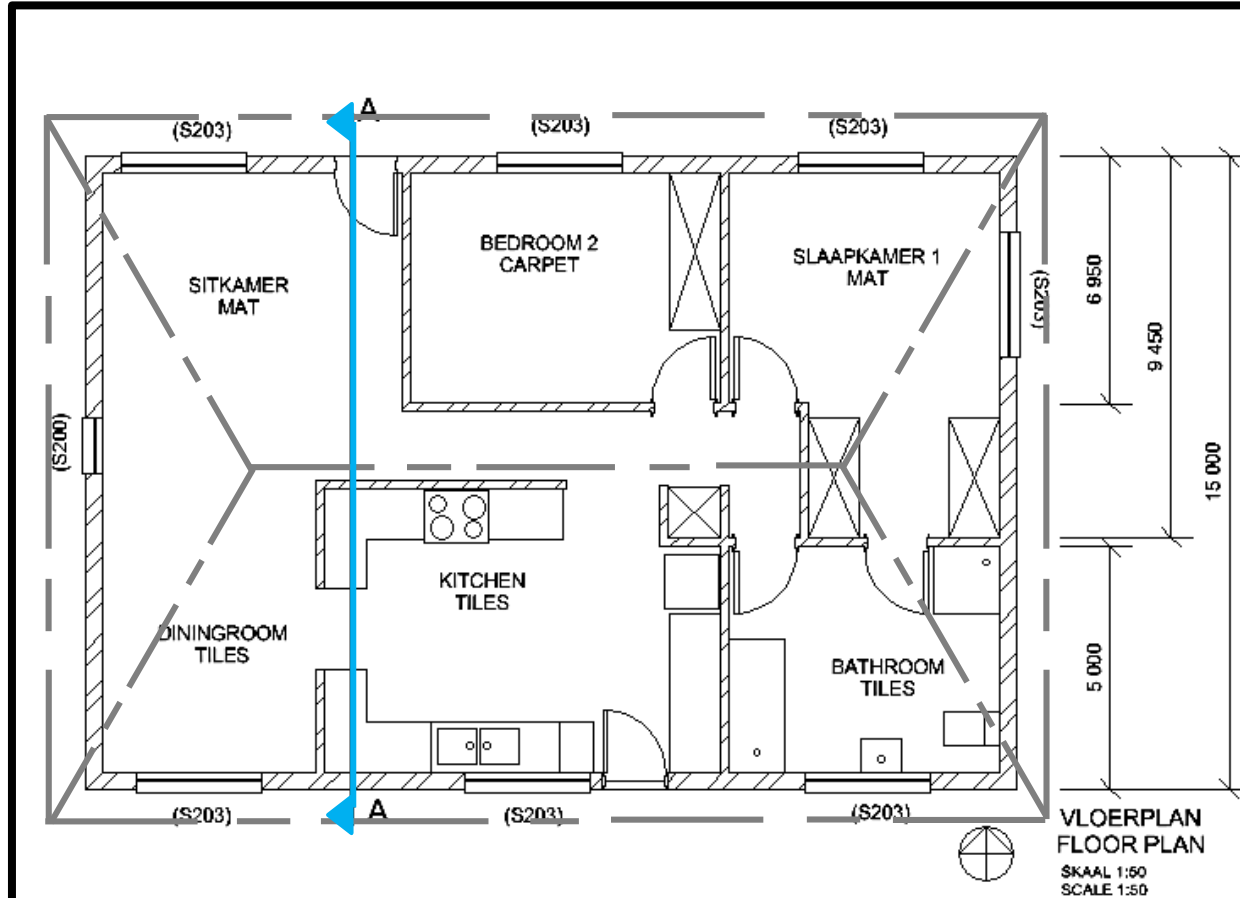

Notes:

1. All windows should be steel.
2. Roof coverage should be tiles
3. All dimensions not shown should be consulted with architect
4. Etc.

Copyright stamp:

Blackey Swart
 &
 Whitey Whitehead
 Architects Ltd
 P.O Box 1001
 Zebra View Valley
 2001

Date print issued:

2016-02-25

Architect/ Engineer/ Planner

J Smuts

Project

Project Title:

Rural Health Development

Drawing Title:

Zebra Health Clinic

Project No:

DoH 071

Drawing No:

Code ref.

Dep. of Health

5

Scale

1:200

Date

2016/02/28

Drawn

V Mabe

Checked

P Nomo



PRESCRIBED CONTENT FOR GRADE 10, 11 & 12

- The floor plan will be evaluated on the following:

6.5	Labels, notes and annotations of...				
6.5.1	The room designations .	1			
6.5.2	The floor coverage of each room.	1			
6.5.3	Outer dimensions of the house.	2			
6.5.4	The cutting plane cutting through a door, non-load bearing wall and a window.	2			

DIMENSIONS

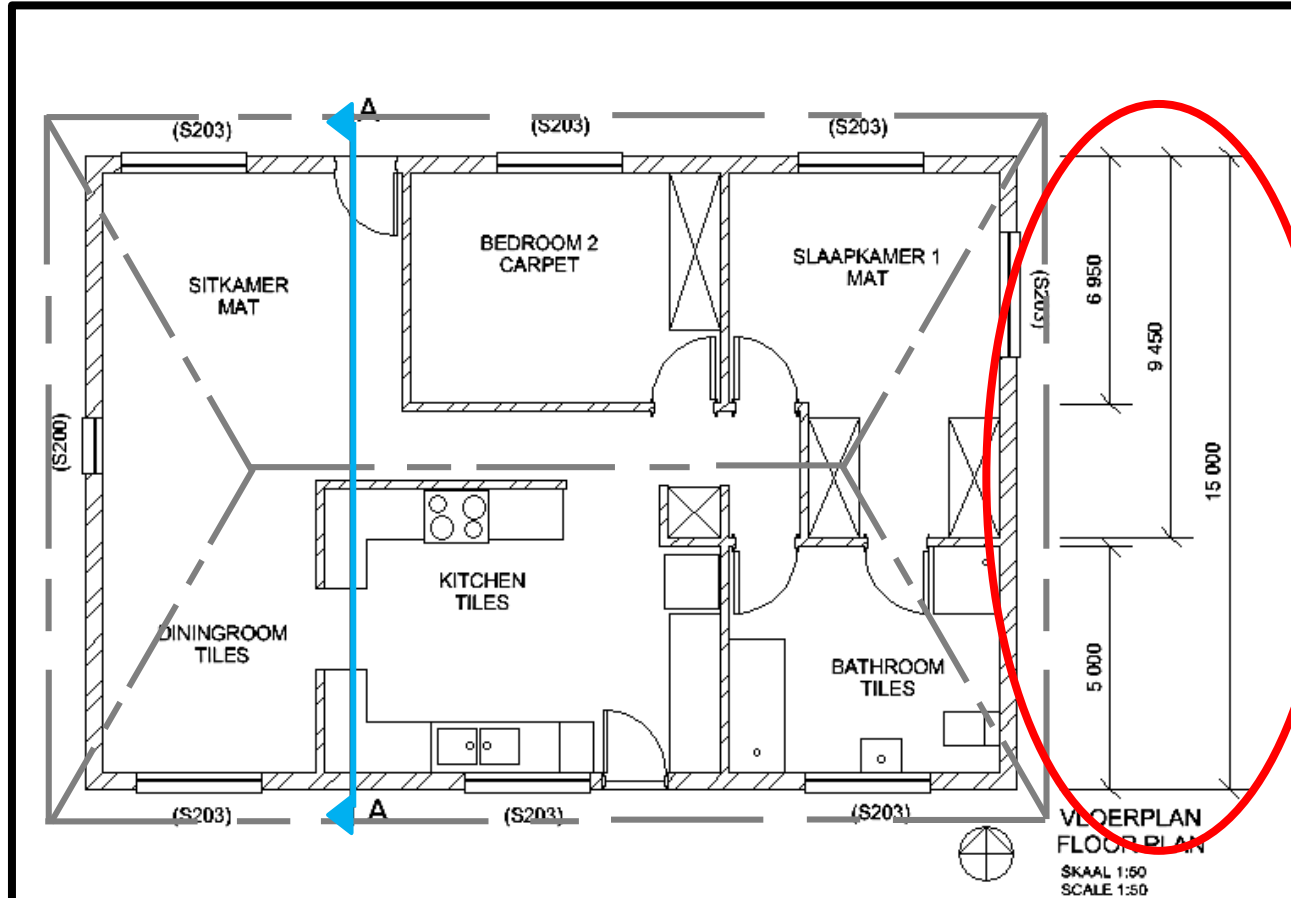

Notes:

1. All windows should be steel.
2. Roof coverage should be tiles
3. All dimensions not shown should be consulted with architect
4. Etc.

Copyright stamp:



Date print issued:

2016-02-25

Architect/ Engineer/ Planner

J Smuts

Project

Project Title:

Rural Health Development

Drawing Title:

Zebra Health Clinic

Project No:

DoH 071

Drawing No:

5

Code ref.

Dep. of Health

Scale

1:200

Date

2016/02/28

Drawn

V Mabe

Checked

P Nomo

HATCHING DETAIL

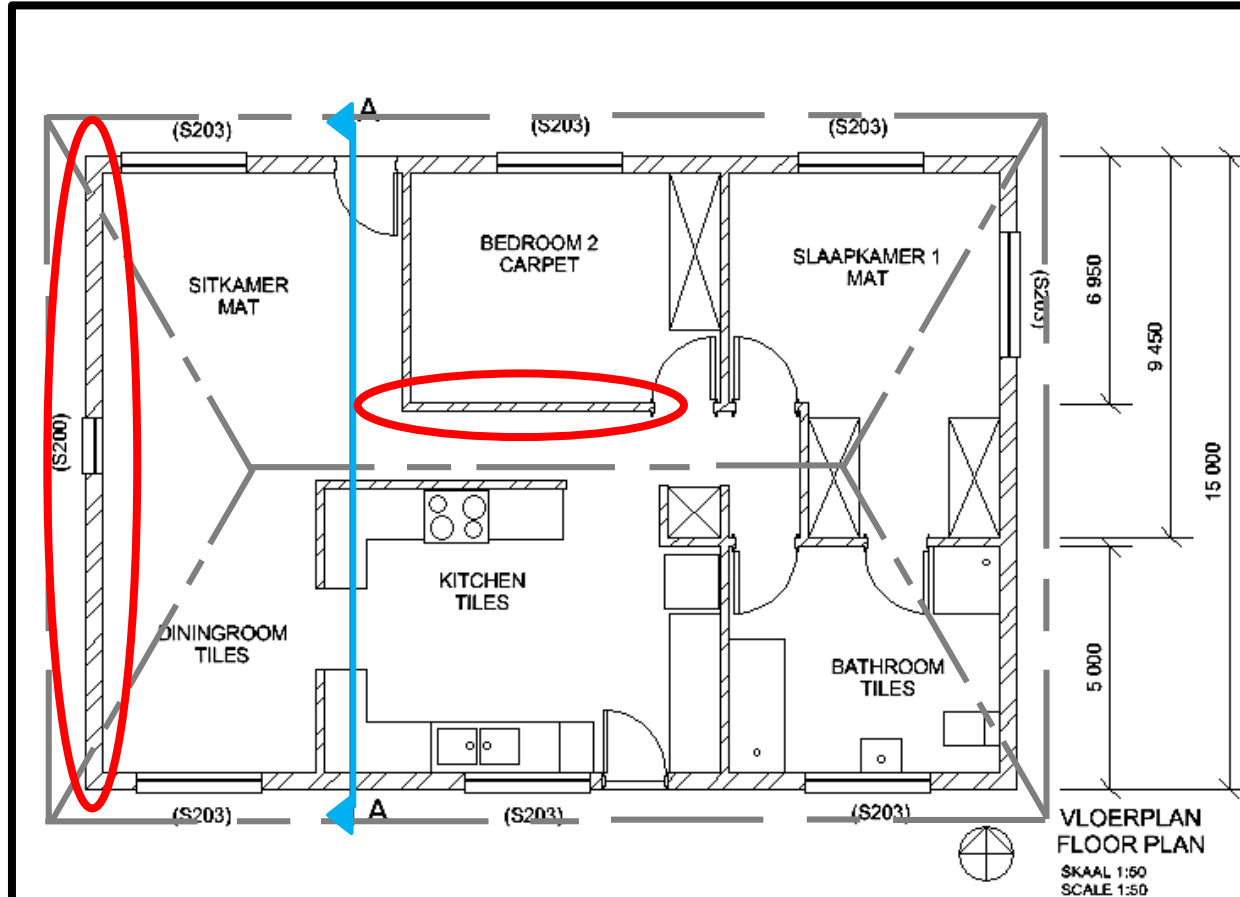

Notes:

1. All windows should be steel.
2. Roof coverage should be tiles
3. All dimensions not shown should be consulted with architect
4. Etc.

Copyright stamp:

Blackey Swart
&
Whitey Whitehead
Architects Ltd
P.O Box 1001
Zebra View Valley
2001

Date print issued:

2016-02-25

Architect/ Engineer/ Planner

J Smuts

Project

Project Title:

Rural Health Development

Drawing Title:

Zebra Health Clinic

Project No:

DoH 071

Drawing No:

5

Code ref.

Dep. of Health

Scale

1:200

Date

2016/02/28

Drawn

V Mabe

Checked

P Nomo



PRESCRIBED CONTENT FOR GRADE 10, 11 & 12

- The floor plan will be evaluated on the following:

6.5	Labels, notes and annotations of...				
6.5.1	The room designations .	1			
6.5.2	The floor coverage of each room.	1			
6.5.3	Outer dimensions of the house.	2			
6.5.4	The cutting plane cutting through a door, non-load bearing wall and a window.	2			

CUTTING PLANE THROUGH DOOR AND WINDOW

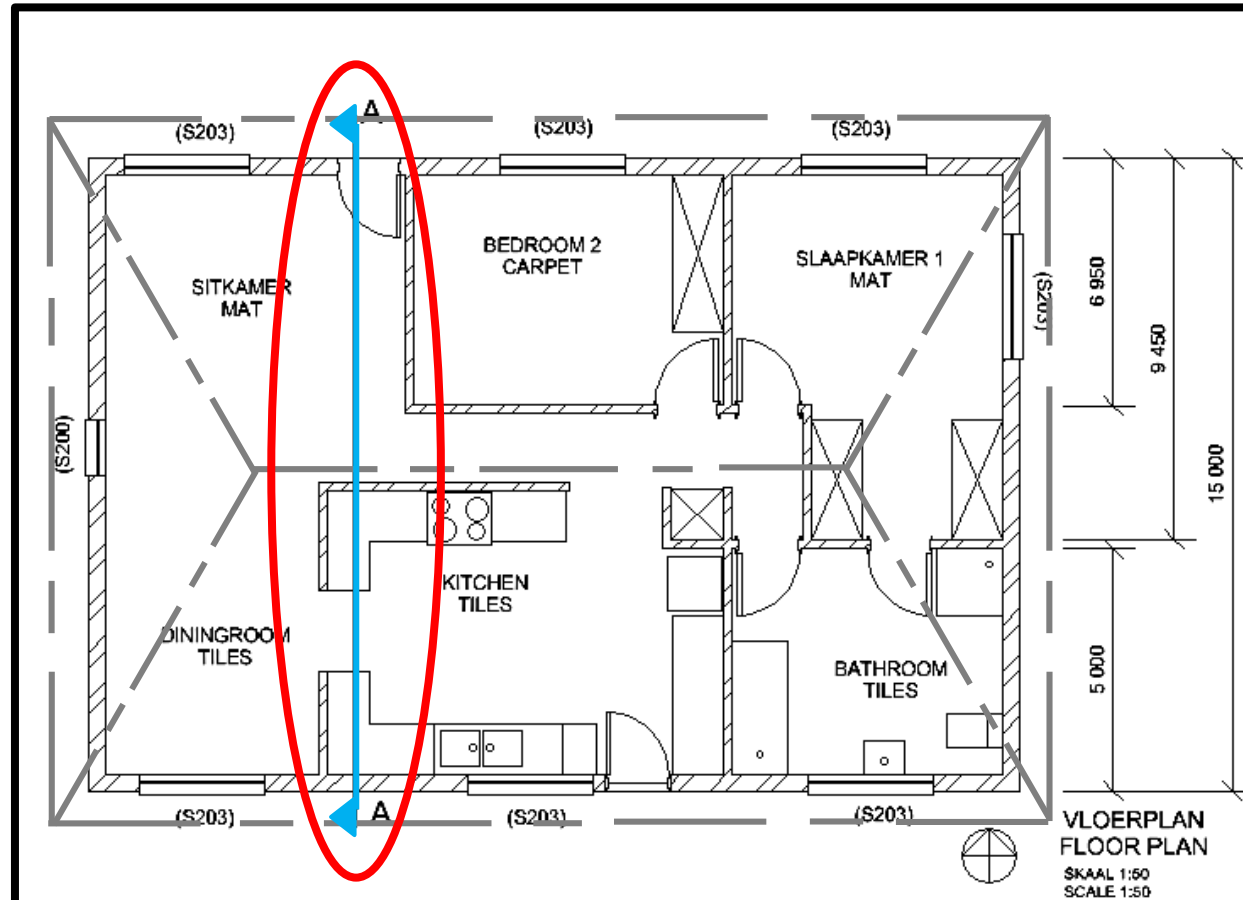

Notes:

1. All windows should be steel.
2. Roof coverage should be tiles
3. All dimensions not shown should be consulted with architect
4. Etc.

Copyright stamp:

Blackey Swart
&
Whitey Whitehead
Architects Ltd
P.O Box 1001
Zebra View Valley
2001

Date print issued:

2016-02-25

Architect/ Engineer/ Planner

J Smuts

Project

Project Title:

Rural Health Development

Drawing Title:

Zebra Health Clinic

Project No:

DoH 071

Drawing No:

Code ref.

Dep. of Health

5

Scale

1:200

Date

2016/02/28

Drawn

V Mabe

Checked

P Nomo

PRESCRIBED CONTENT FOR GRADE 10, 11 & 12

- The floor plan will be evaluated on the following:

6.5.5	The calculated surface area of the dwelling .	2			
6.5.6	The suitable scale used for this drawing.	2			
6.5.7	Indicate the scale of the drawing.	1			
6.5.8	Indicate the North point.	1			
	TOTAL (20 ÷ 2)	10			

CALCULATION OF THE FLOOR AREA

- Floor area:
= $(L \times B) + (L \times B)$
= $(4,6 \text{ m} \times 4 \text{ m}) + (2 \text{ m} \times 2,4 \text{ m})$
= $(18,4 \text{ m}^2) + (4,8 \text{ m}^2)$
= $23,2 \text{ m}^2$

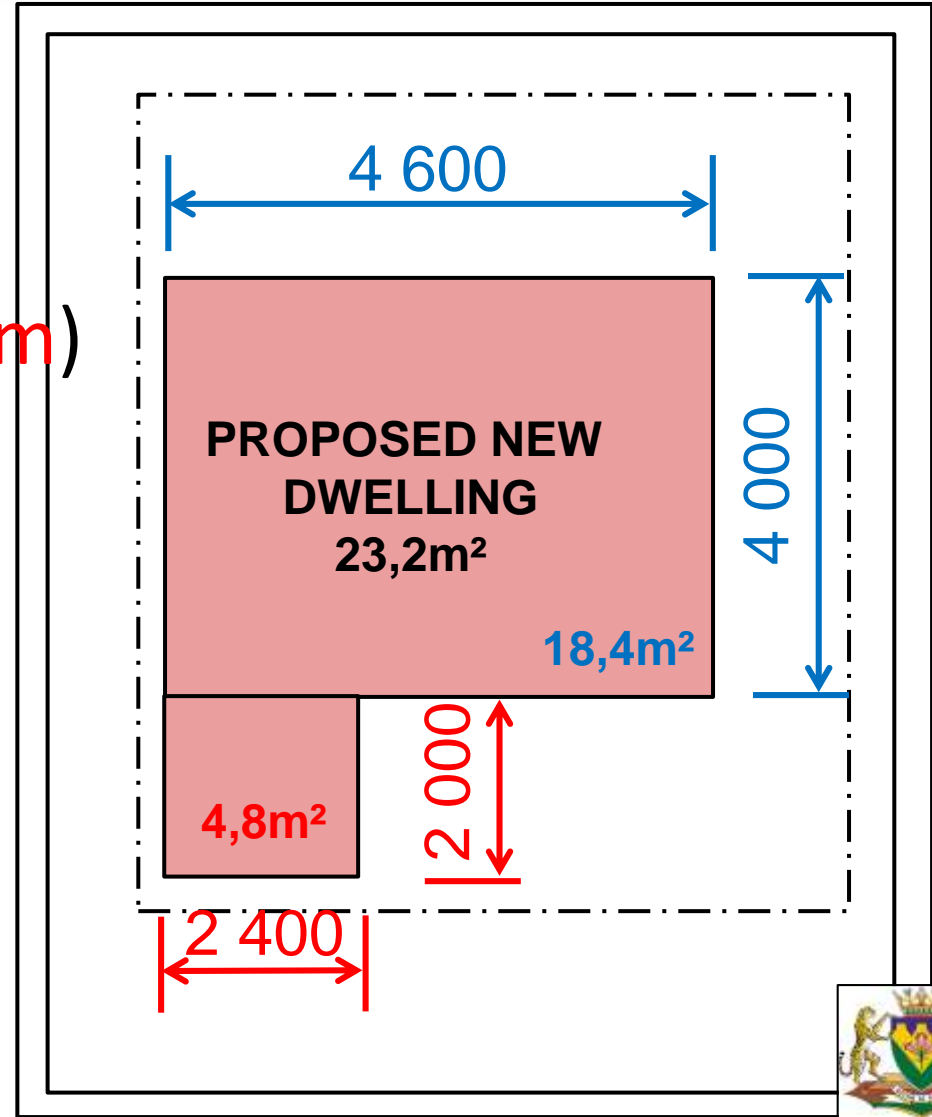

PRESCRIBED CONTENT FOR GRADE 10, 11 & 12

- The floor plan will be evaluated on the following:

6.5.5	The calculated surface area of the dwelling .	2			
6.5.6	The suitable scale used for this drawing.	2			
6.5.7	Indicate the scale of the drawing.	1			
6.5.8	Indicate the North point.	1			
	TOTAL (20 ÷ 2)	10			

SUITABLE SCALE

- Determine the correct scale to fit the drawing

(S203) (S203) (S203)
 SITKAMER MAT
 BEDROOM 2 CARPET
 SLAAPKAMER 1 MAT
 (S203)
 6 950
 9 450
 15 000
 (S200)
 DININGROOM TILES
 KITCHEN TILES
 BATHROOM TILES
 5 000
 (S203) (S203) (S203)
 VLOERPLAN FLOOR PLAN
 SKAAL 1:50
 SCALE 1:50

1. All windows should be tiled
 2. Roof coverage should be tiles
 3. All dimensions not shown should be consulted with architect
 4. Etc.

Copyright stamp:
 Blackey Swart & Whitey Whitehead Architects Ltd
 P.O Box 1001 Zebra View Valley 2001

Date print issued:
 2016-02-25

Architect/ Engineer/ Planner
 J Smuts

Project
 Project Title:
 Rural Health Development

Drawing Title:
 Zebra Health Clinic

Project No:
 DoH 071

Drawing No:
 5

Code ref.
 Dep. of Health

Scale 1:200	Date 2016/02/28	Drawn V Mabe	Checked P Nomo
----------------	--------------------	-----------------	-------------------

PRESCRIBED CONTENT FOR GRADE 10, 11 & 12

- The floor plan will be evaluated on the following:

6.5.5	The calculated surface area of the dwelling .	2			
6.5.6	The suitable scale used for this drawing.	2			
6.5.7	Indicate the scale of the drawing.	1			
6.5.8	Indicate the North point.	1			
	TOTAL (20 ÷ 2)	10			

NORTH ARROW

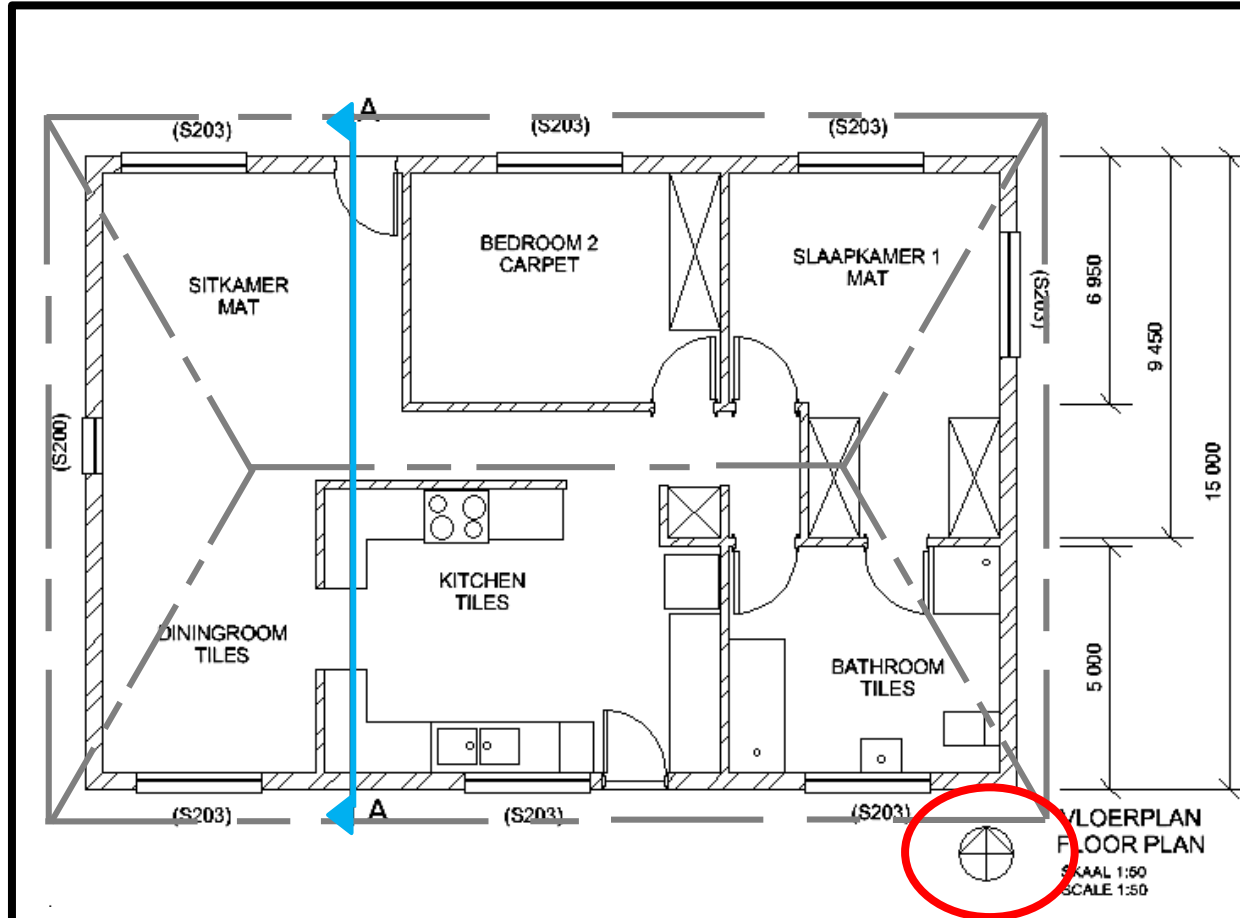

Notes:

1. All windows should be steel.
2. Roof coverage should be tiles
3. All dimensions not shown should be consulted with architect
4. Etc.

Copyright stamp:



Date print issued:

2016-02-25

Architect/ Engineer/ Planner

J Smuts

Project

Project Title:

Rural Health Development

Drawing Title:

Zebra Health Clinic

Project No:

DoH 071

Drawing No:

5

Code ref.

Dep. of Health

Scale

1:200

Date

2016/02/28

Drawn

V Mabe

Checked

P Nomo