

**QUESTION 2: INTERPENETRATION AND DEVELOPMENT**

**Given:**

- The casting of an incomplete front view and the top view of a cylinder that has been shaped to fit around a right regular pentagonal prism.
- The cylinder and the prism are solid.
- The axes of the cylinder and the prism lie in a common vertical plane.
- The auxiliary view of the cylinder.
- The position of point O on the drawing sheet.

**Instructions:**

Draw to scale 1 : 1, the following views of the cylinder and the prism:

- 2.1 The given top view
- 2.2 The complete front view, clearly showing the curve of interpenetration
- 2.3 The left view
- 2.4 Develop the surface of the pentagonal prism. Clearly show the points of interpenetration. Use point A to B as the start position.
- 2.5 Develop the surface of the cylinder. Use point S as the start position.

Show all hidden detail and fold lines.

**[55]**

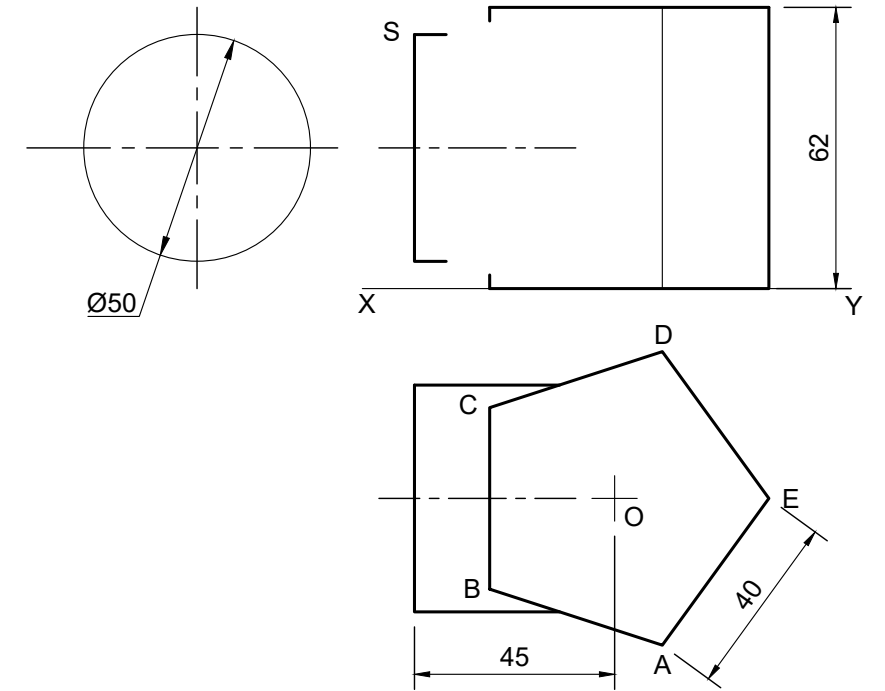

ASSESSMENT CRITERIA			
1	TOP VIEW	4.5	
2	FRONT VIEW	9.5	
3	LEFT VIEW	5.5	
4	DEVELOPMENT PENTAGON	18.5	
5	DEVELOPMENT CYLINDER	17	
PENALTIES (-)			
<b>TOTAL</b>		<b>55</b>	



<b>INTERPENETRATION &amp; DEVELOPMENTS</b>	ESTIMATED TIME FOR COMPLETION	35 MIN	GRADE <b>11</b>	NAME & SURNAME	TASK <b>8.4</b>	PAGE <b>34</b>
	YOUR TIME OF COMPLETION	MIN				