

QUESTION 2: INTERPENETRATION AND DEVELOPMENT

Given:

- The incomplete front view and the top view of a regular triangular pipe that has been shaped to fit around a round pipe.
- The axes of both prisms lie in a common vertical plane.
- The auxiliary views of the triangular pipe.
- The position of point O on the drawing sheet.

Instructions:

Draw to scale 1 : 1, the following views:

- 2.1 The given top view
- 2.2 The complete front view, clearly showing the curve of interpenetration
- 2.3 Develop the surface of the round pipe. Use point 1 - 2 as the start position.
- 2.4 Develop the surface of the triangular pipe. Use point A as the start position.

Show all construction lines, calculations and fold lines. **[33]**

o

A

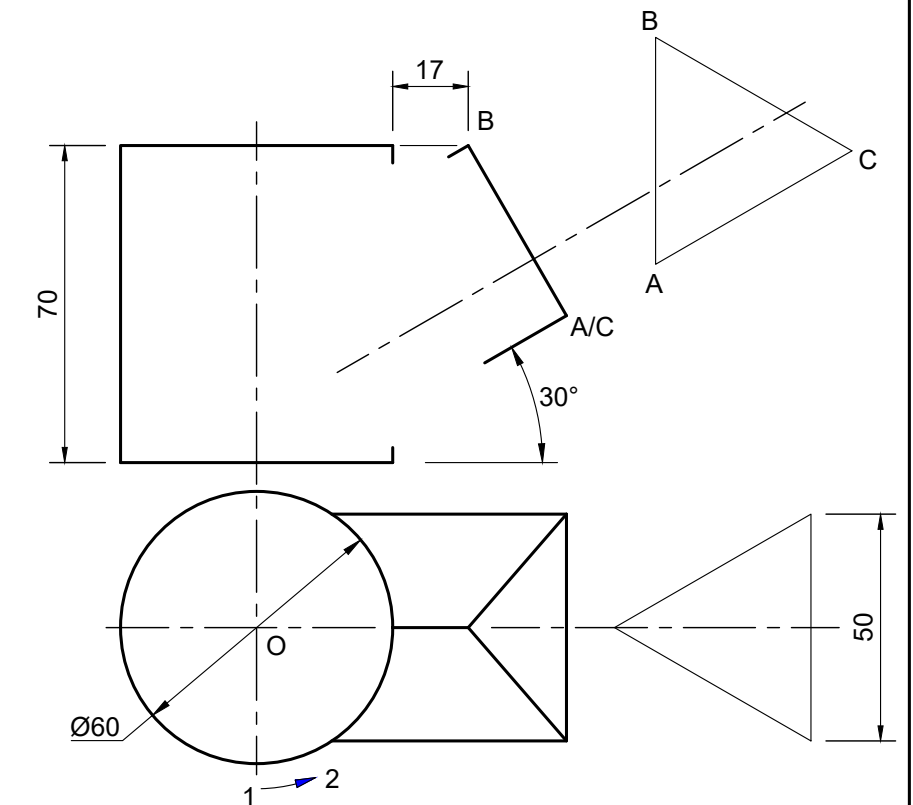

1

ASSESSMENT CRITERIA			
1	TOP VIEW	4.5	
2	FRONT VIEW	6.5	
4	DEVELOPMENT - CIRCLE	11.5	
5	DEVELOPMENT - TRIANGLE	10.5	
PENALTIES (-)			
TOTAL		33	



INTERPENETRATION & DEVELOPMENTS	ESTIMATED TIME FOR COMPLETION	35 MIN	GRADE	NAME & SURNAME	TASK	PAGE
	YOUR TIME OF COMPLETION	MIN	11			