



QUESTION 2: INTERPENETRATION AND DEVELOPMENT

Given:

- The incomplete front view and the top view of a regular square prism that has been shaped to fit around a right regular hexagonal prism. The axes of both prisms lie in a common vertical plane.
- The auxiliary view of the square prism
- The position of point O on the drawing sheet

Instructions:

Draw, to scale 1 : 1, the following views of the TWO prisms:

- 2.1 The given top view
- 2.2 The left view
- 2.3 The complete front view, clearly showing the curve of interpenetration
- 2.4 Develop the surfaces of the square prism.

Show ALL hidden detail and fold lines.

[35]

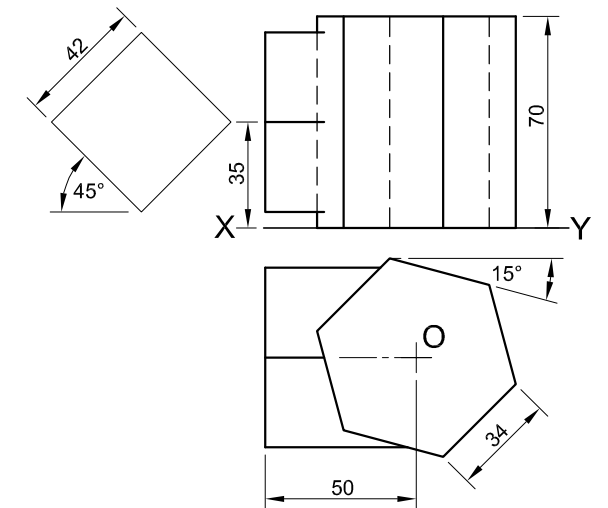

+O

ASSESSMENT CRITERIA				
1	TOP VIEW	6		
2	LEFT VIEW	5		
3	FRONT VIEW	14		
4	DEVELOPMENT	10		
TOTAL		35		
EXAMINATION NUMBER				
EXAMINATION NUMBER				3

